



22" HAND SANITIZER DISPLAY USER MANUAL

CONTENTS

SUBJECT	PAGE
1. Technical Specification	3
2. Parts and Mounting	4
- Packing List	4
- Steps for Mounting (Wall Mounted)	4
- Steps for Mounting (Freestanding)	5
3. Using the Display for the First Time	6
- Screen Checks	6
4. Remote Control	9
5. Installing/Updating the TOPAZ Content Player Software	10
6. Updating the Display via USB (Gold Package)	13
7. Connecting the Display to the TOPAZ Cloud Content Player (Platinum Package)	15
8. Managing Your Displays via the TOPAZ Cloud Content Player (Reseller Account)	17
- Logging In	17
- Creating and Managing Customers	18
- Creating and Managing Users	20
- Managing and Assigning Screens	21
- Assigning Content to a Screen	24
9. Managing Your Displays via the TOPAZ Cloud Content Player (Customer Account)	26
- Logging In	26
- Managing Media	27
- Creating and Managing Users	29
- Managing Screens	30
- Uploading Content via the Screen Section	31
- Assigning and Publishing Content to a Screen	31

TECHNICAL SPECIFICATIONS

MODEL NUMBER	TPZ-HSD-22WP (Wall Mounted) TPZ-HSD-22FP (Freestanding)
Panel	
MAX RESOLUTION	1080 x 1920
ASPECT RATIO	9:16
PIXEL PITCH	0.24825 x 0.24825
VIEWING ANGLE	89/89/89/89
CONTRAST RATIO	3000:1
BRIGHTNESS	500cd/m2
RESPONSE TIME	18ms
REFRESH RATE	60Hz
COLOUR SATURATION	68%
VIEWABLE AREA	268.11 x 476.64 mm
CHROMATICNESS	16.7M
INPUT PORTS	
USB 2.0	X2
HDMI OUT	X1
SD	X1
RJ45	X1
SUPPORTED MEDIA	
VIDEO	RMVB,FLV,MPEG1/2/4,AVI,DIVX,XDIV,WMV9,H.264
IMAGE	BMP/PNG/GIF/JPEG
AUDIO	MP3,WMA,WAV
GENERAL	
MATERIAL	Metal
COLOUR	White
CERTIFICATION	CE/ROHS/FCC
24/7 OPERATION?	Yes
PC SPECIFICATIONS	
OPERATING SYSTEM	Android 7.1
PROCESSOR	RK3288 board Quad-core ARM Cortex-A17, 1.8GHz
DDR3	2GB
FLASH	8GB
MECHANICAL	
NET WEIGHT	18kg (screen) 10kg (stand) *Freestanding only
GROSS WEIGHT	22kg (screen) 30kg (stand) *Freestanding only
UNIT DIMS	618.6 x 70 x 290.9 (screen) 450 x 350 x 1018 (stand) *Freestanding only
PACKAGE DIMS	800 x 320 x 530 (screen) 1100 x 490 x 630 (stand) *Freestanding only
MATERIAL	Metal
COLOUR	White
SANITIZER VOLUME	5000ml
POWER/ENVIRONMENT	
VOLTAGE	AC100-240V
POWER CONSUMPTION	60W
OPERATING TEMPERATURE	32~104 °F (0~40 °C)

PARTS AND MOUNTING

Packing List

Wall Mounted
1x Power Cord
3x Keys
1x 6mm Allen Wrench
2x M4x30 screws

Freestanding
1x Power Cord
4x Keys
1x 6mm Allen Wrench
6x M8x25 screws
4x Foot Pad

Steps for Mounting – Wall Mounted

1. Securely fix the wall bracket onto the back of the screen.
2. Using two people, lift the display onto the bracket.
3. Screw the small fixing screw into the side of the bracket to lock the screen in place.

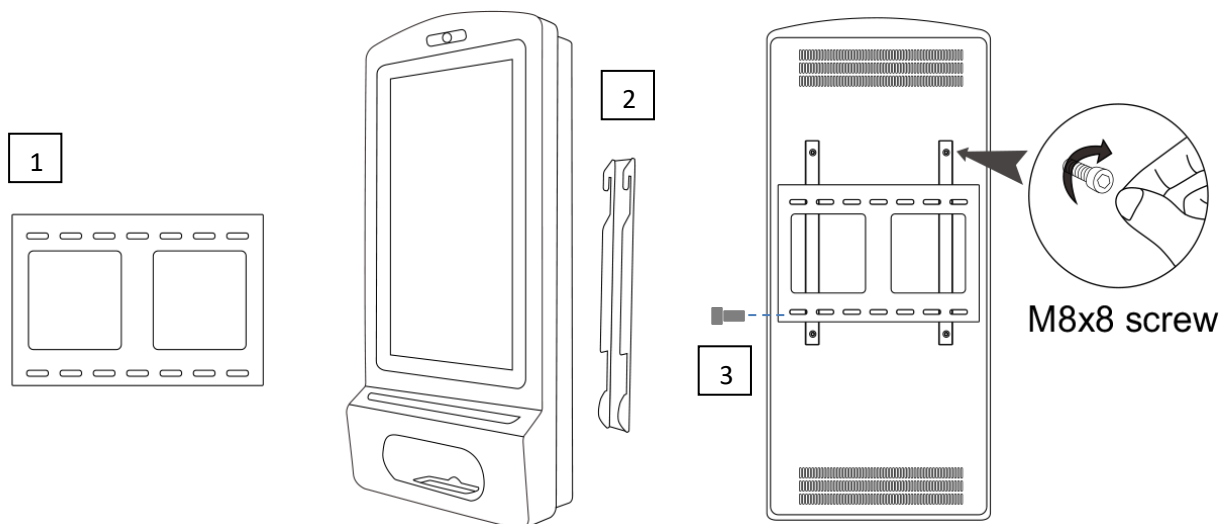

Steps for Mounting – Freestanding

1. Place the floor plate in location and bolt to the floor using M8 Bolts.
2. Slide Floor stand onto floor plate and screw in place
3. Using two people, carefully lift the display onto the floor stand
4. Use M8 screws to secure the frame into the bottom of the screen.
5. Lock Stand to Base tightly with the key

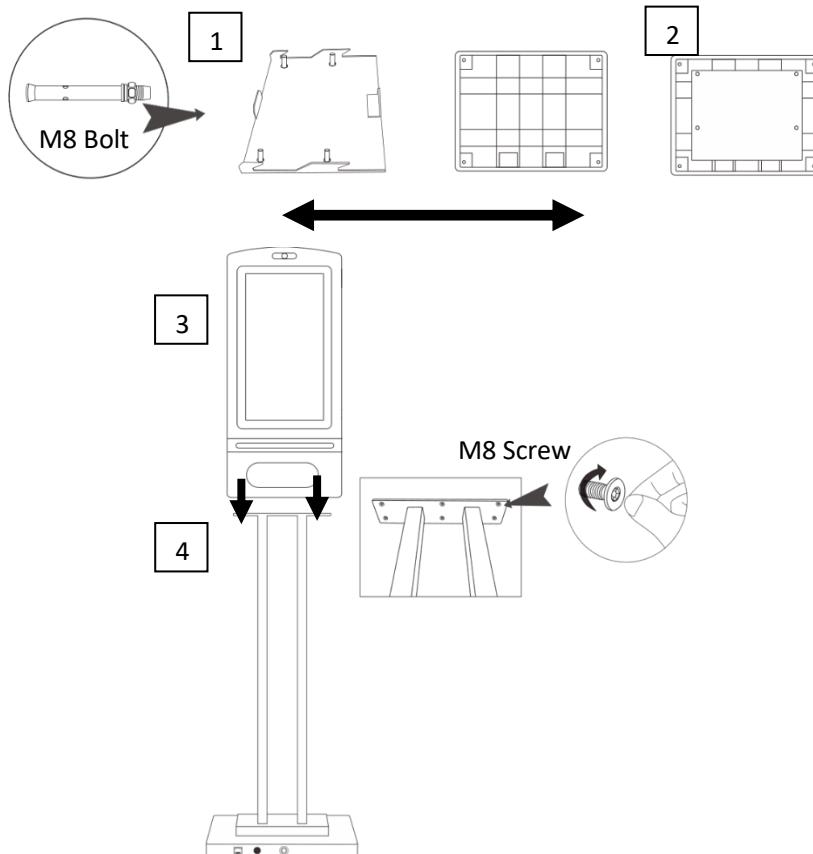

1) Bolt Plate to floor

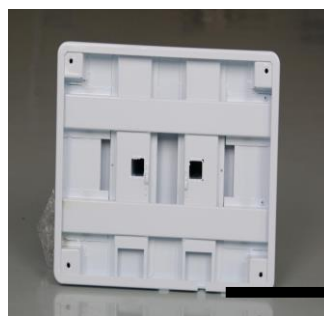

2) Slide floor stand onto floor plate

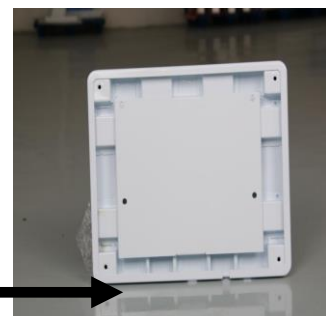

5) Lock Stand to Base tightly with the key

NOTE – Please ensure that the floor stand is securely bolted to the floor. TOPAZ Digital will not be held liable for any damage or injury for failure to do so.

USING THE DISPLAY FOR THE FIRST TIME

Screen Checks

1. Power on the display and check volume indicator

Power on the display. The sanitizer volume indicator should display as red.



2. Checking Dispenser Border Light

The dispenser border light should display as blue when not in use. Place your hand in the dispenser to activate the sensor. A click should be heard and the border light should change to green.



3. Deciding what type of Sanitizer you wish to use

Before use, please decide whether Liquid or Gel Sanitizer will be used.

4. Opening the unit

Use the keys provided to open the two locks on the side of the unit and carefully open the display



5. Liquid Sanitizer

If you are using liquid sanitizer, ensure that the button highlighted below is pressed **IN**.



Ensure the following dispenser head is being used for **Liquid Sanitizer**:



6. Gel Sanitizer

If you are using Gel sanitizer, ensure that the button highlighted below is pressed **OUT**.



Ensure the following dispenser head is being used for **Gel Sanitizer**:



NOTE – to change the dispenser, simply unscrew and replace.











7. Pour in your Sanitizer

Unscrew the blue cap and carefully pour in your required sanitizer.



REMOTE CONTROL



-  1. Power off button
-  2. Press this button to return to Home screen
-  3. Press MENU to organize screen and apps
-  4. Mute.
-  5. Move selection Up
-  6. Move Selection Down
-  7. Move selection Left
-  8. Move selection Right
-  9. Enter – press to confirm selection
-  10. Volume up
-  11. Volume Down
-  12. Exit – Press to return to previous page.

NOTE – Only buttons shown above have functions

INSTALLING/UPDATING THE TOPAZ CONTENT PLAYER SOFTWARE

1. Request the latest APK installation file from TOPAZ Digital or your reseller.
2. On your computer, copy the APK file onto a blank USB memory stick. Once copied, safely remove the USB from your computer.

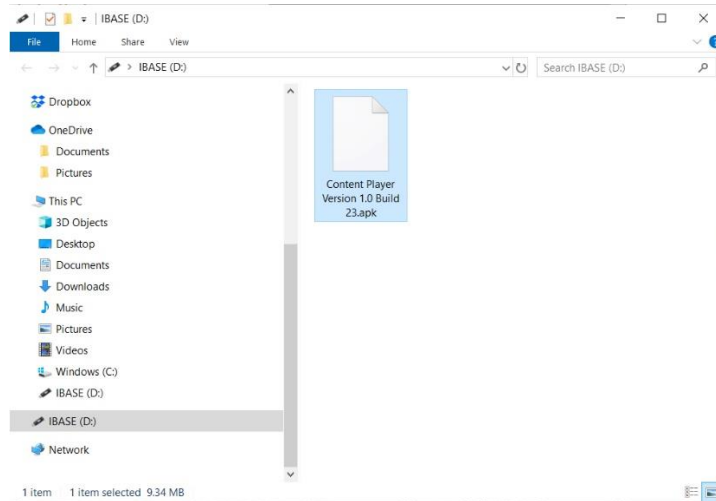

3. Turn on the Hand Sanitizer Display
4. Use the keys provided to open the two locks on the side of the unit and carefully open the display

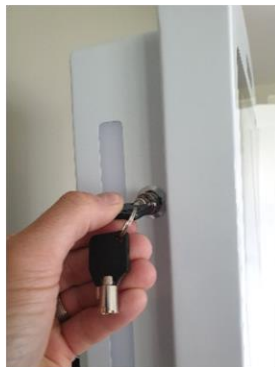

5. Insert the USB memory stick into USB Port 1 and a USB mouse into USB Port 2.

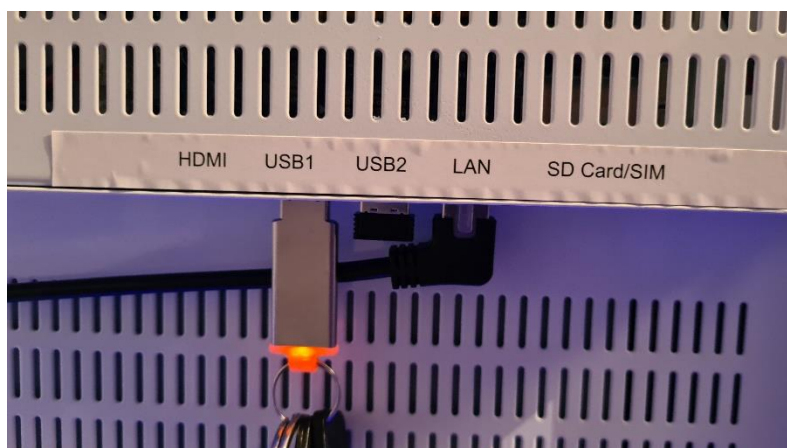

6. A pop up will appear in the middle of the screen and the black Android navigation bar will appear at the bottom of the display. Click the white circle in the centre of the bottom black bar (circled below)

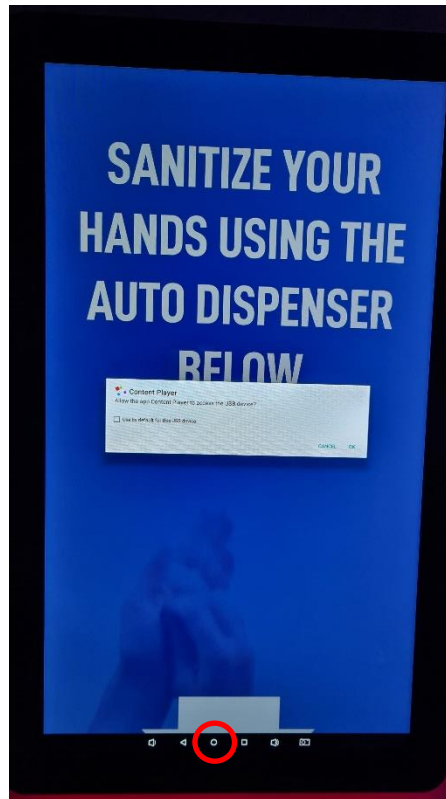

7. Select the white circle highlighted below

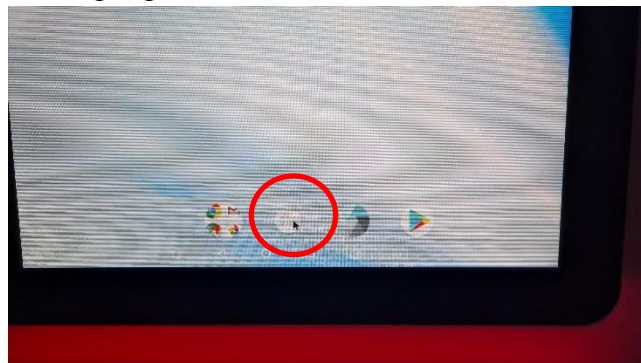

8. Select the 'Explorer' icon highlighted below

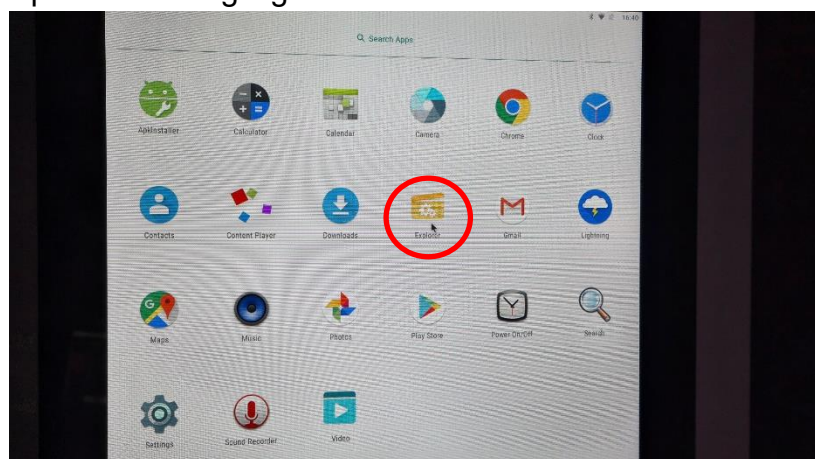

9. Select USB

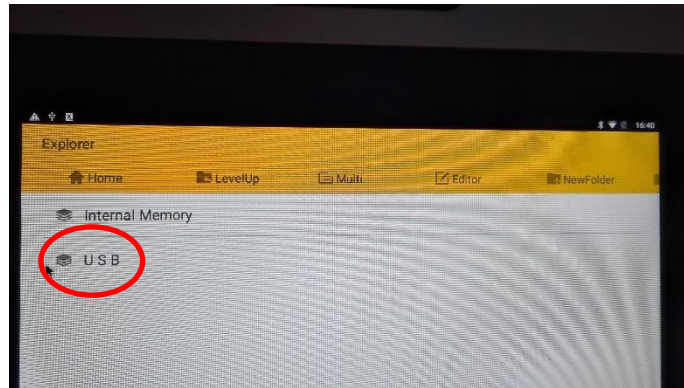

10. Select the Content Player APK file saved on the USB

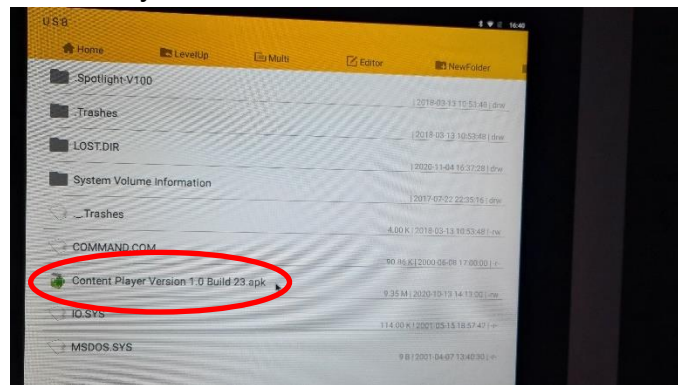

11. Select 'Install' and the APK will install onto the unit. Once complete, click Open

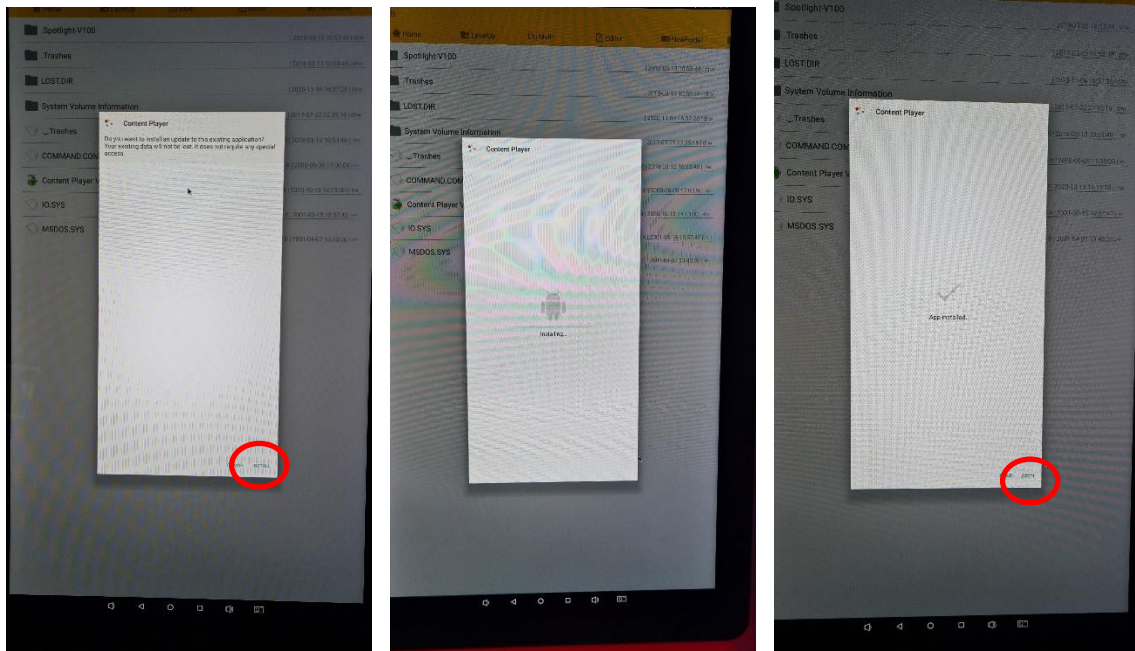

12. The Content will now begin to play and the software has been successfully installed.

UPDATING THE DISPLAY VIA USB

Your TOPAZ Hand Sanitizer Display will come with the TOPAZ Content Player Software pre-installed. However, this may need updating/reinstalling. Please follow the guide below on how to do this.

13. On your computer, copy your content (jpgs and/or videos as above) onto a blank USB memory stick. Once copied, safely remove the USB from your computer.

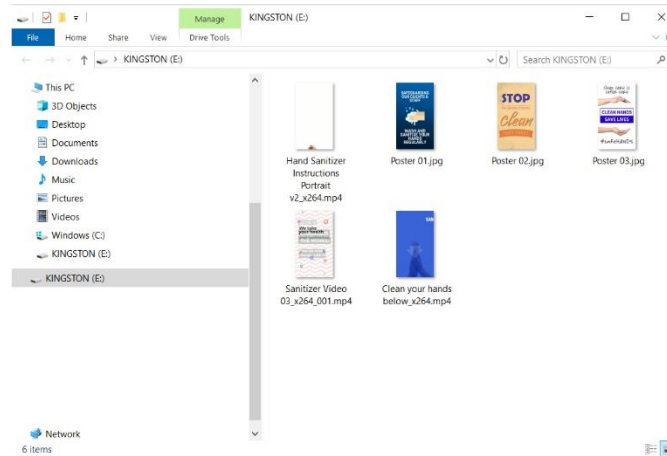

14. Use the keys provided to open the two locks on the side of the unit and carefully open the display

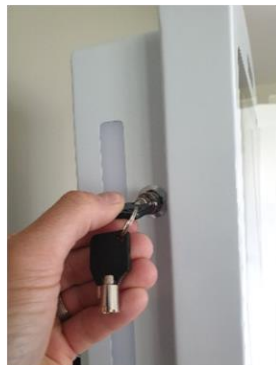

15. Insert the USB into USB Port 1. The content will update on the display.

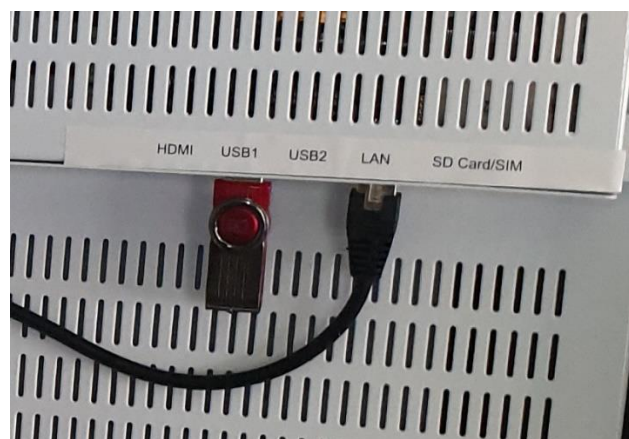

16. When the first pop up message appears, use a USB mouse to click the checkbox 'Use by default for this USB device?' and click OK (a USB mouse can be inserted into USB2).

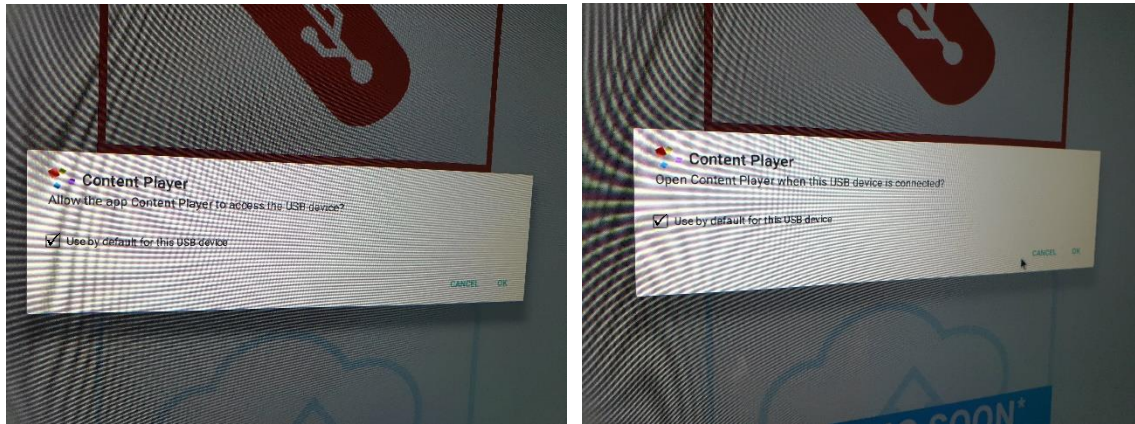

NOTE – This only needs to be done once for a particular USB memory stick. When content is updated in the future using the same USB memory stick is used, it will automatically update

17. Your content will now update. Ensure all content is playing and remove the USB stick.

CONNECTING THE DISPLAY TO THE TOPAZ CLOUD CONTENT PLAYER (PLATINUM PACKAGE)

If you have a Platinum Package subscription, you will have received login details for the TOPAZ Content Player CMS and screen License and Serial Information. Please have this information to hand and follow the instructions below to connect the display to the Cloud Content player CMS.

NOTE – Ensure your screen is connected to the internet via LAN or WiFi

1. Insert a USB mouse into the USB port on the display and turn the display on.



2. When the screen has booted up and content starts playing, click the left mouse button on the centre of the content.



3. A screen will appear asking for the License Key and Serial Number. Enter this information and click 'Register'. (note – connecting a USB keyboard to the screen will speed up the input of this information).

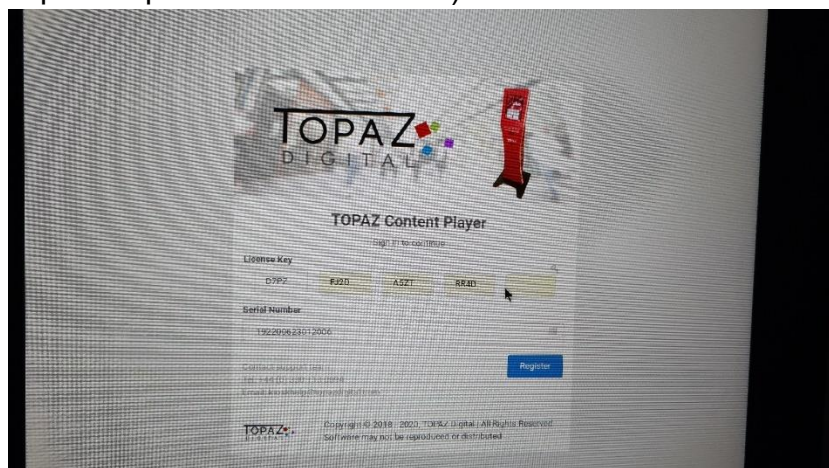

4. Login to your Content Player Cloud account and click on 'Screens'. Next to the screen name there should be a green 'tick'. This means that the screen has been successfully linked to the internet and is communicating with the server.

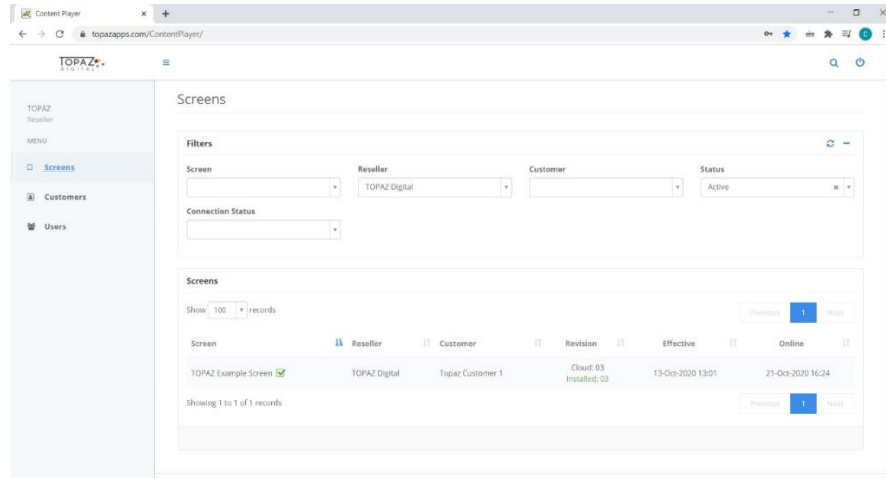

5. If there is an orange 'cross', either the Serial/License info has been input incorrectly or the screen does not have internet access.

MANAGING YOUR DISPLAYS VIA THE TOPAZ CLOUD CONTENT PLAYER (RESELLER ACCOUNT)

Logging In

Once your display(s) have been registered for the Platinum package, you will receive your login details which will allow you to manage your display(s) via the Cloud. Below is how to manage your account as a Reseller

1. Open your browser (Chrome recommended) and go to <https://topazapps.com/ContentPlayer/>. Login using the details provided

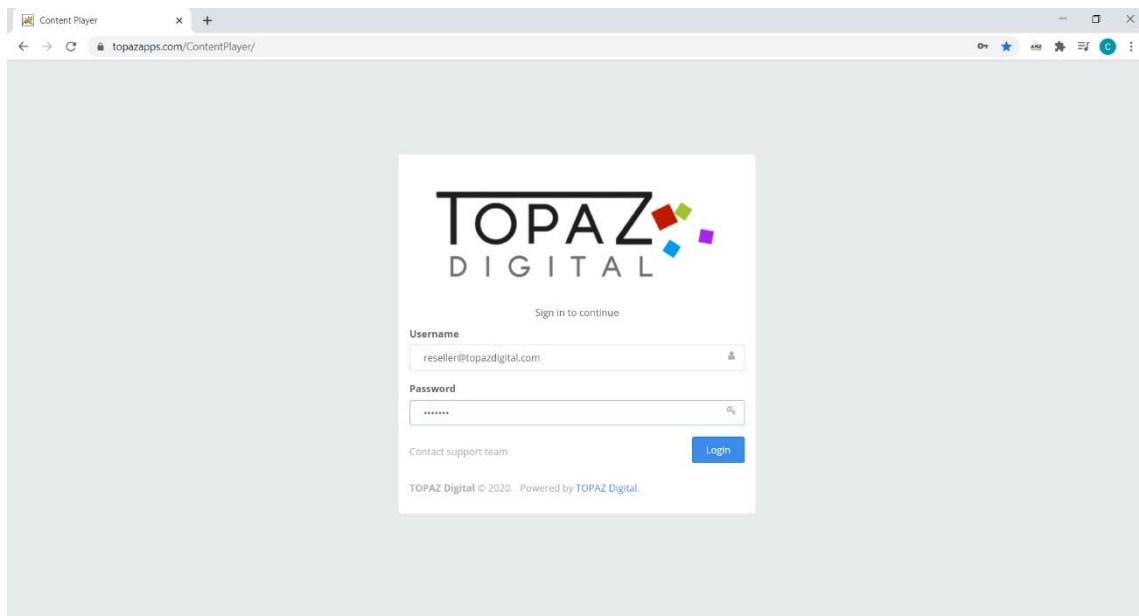

2. Once logged into your account, you will see the 'Screens' section. This will show all screens assigned to your reseller account by TOPAZ. In the demo screen below, you can see an orange cross by the screen name (circled below). This means that your screen is currently offline.

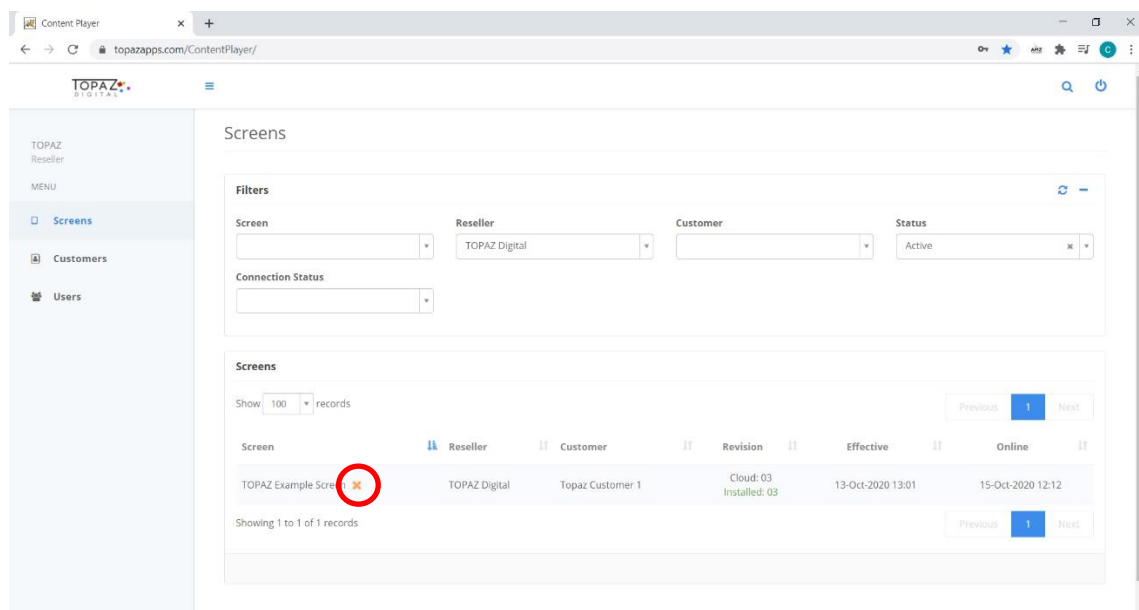

- Once your screen is connected to the internet, this will change to a green tick (see below). Your screen cannot be updated via the cloud unless it is online.

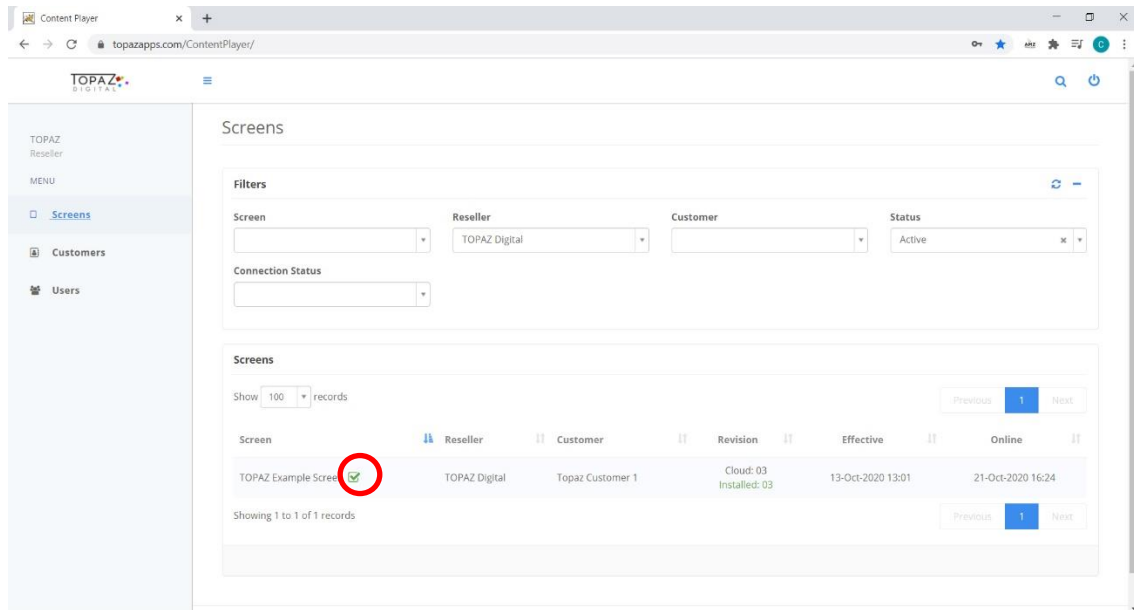

Creating and Managing Customers

- As a reseller, when you have sold a screen to a new customer, you will need to create a new Customer Organization. This will then allow you assign screens and user logins to this organization.
Click on 'Customers' on the left side menu and this will display a list of your current customer organizations. To manage an existing organization click on the name, to create a new one click 'Add New'

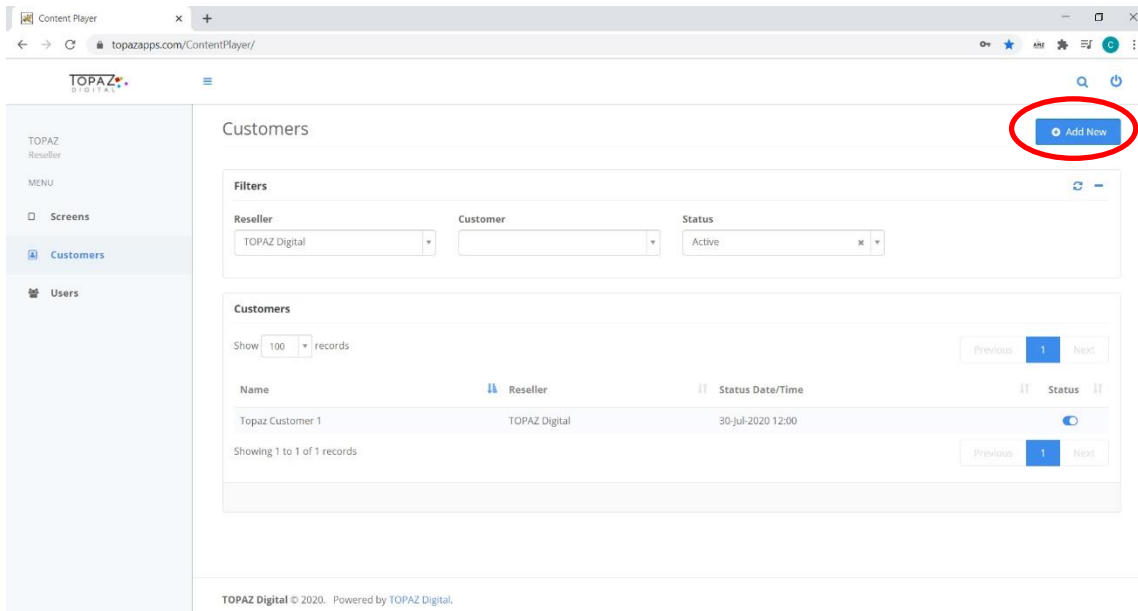

- When 'Add New' is clicked you will be taken to the 'Add New Customer' screen. Simply type the name of the customer (Customer 2 in this example) and click 'Save'

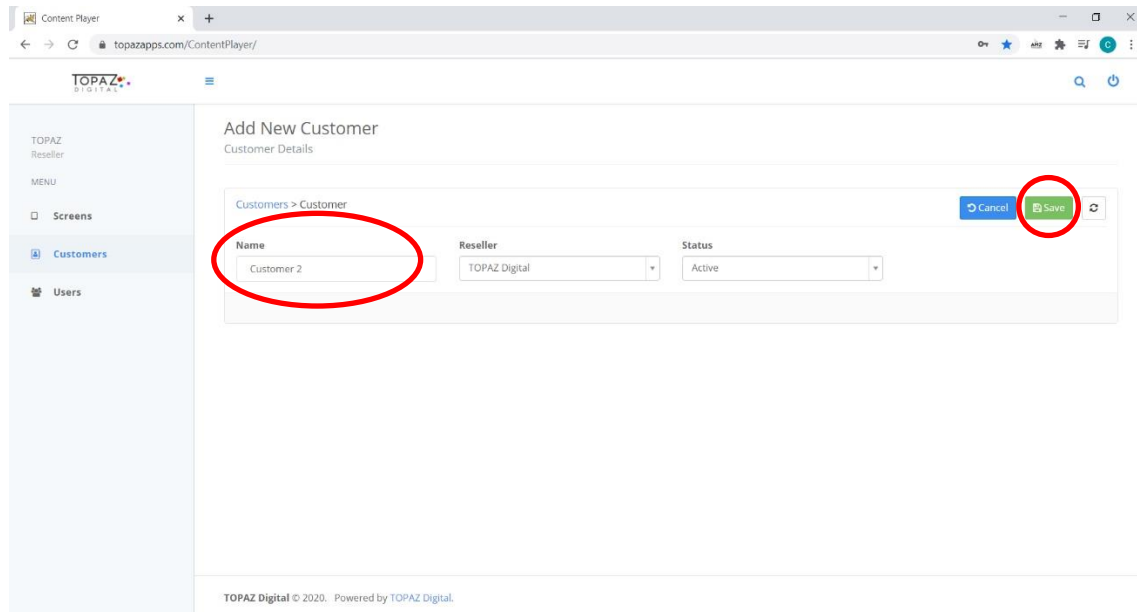

Content Player x +

topazapps.com/ContentPlayer/

TOPAZ DIGITAL

TOPAZ Reseller

MENU

Screens

Customers

Users

Add New Customer

Customer Details

Customers > Customer

Cancel Save

Name

Customer 2

Reseller

TOPAZ Digital

Status

Active

TOPAZ Digital © 2020. Powered by TOPAZ Digital.

- You will now see this appear in your list of Customers.

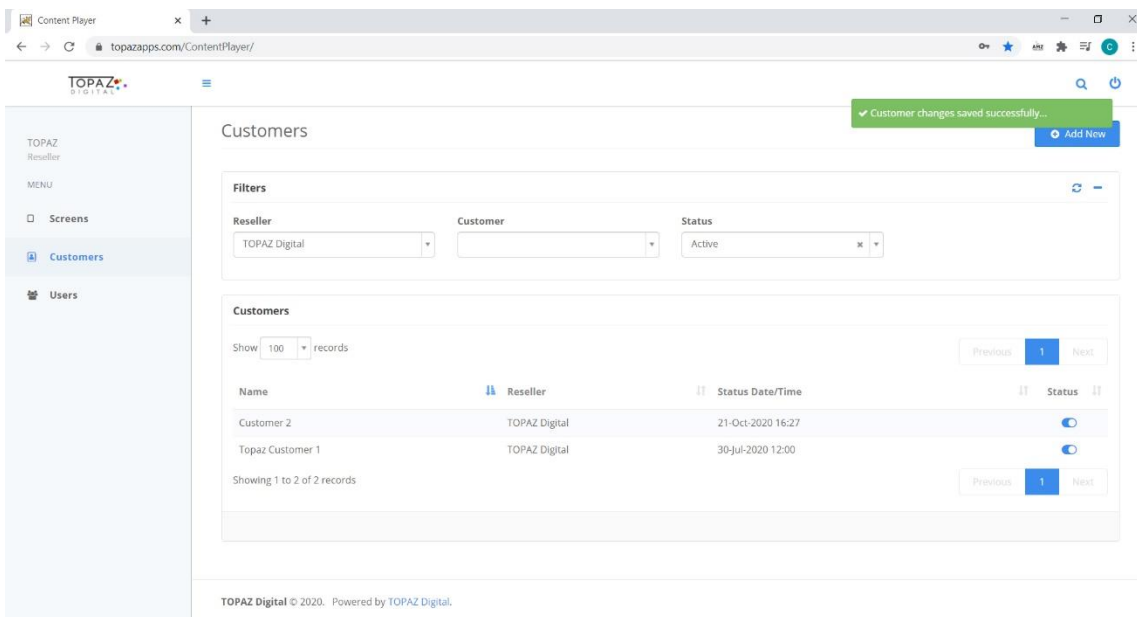

Content Player x +

topazapps.com/ContentPlayer/

TOPAZ DIGITAL

TOPAZ Reseller

MENU

Screens

Customers

Users

Customers

Customer changes saved successfully...

Add New

Filters

Reseller

TOPAZ Digital

Customer

Status

Active

Customers

Show 100 records

Previous 1 Next

Name	Reseller	Status Date/Time	Status
Customer 2	TOPAZ Digital	21-Oct-2020 16:27	Active
Topaz Customer 1	TOPAZ Digital	30-Jul-2020 12:00	Active

Showing 1 to 2 of 2 records

Previous 1 Next

TOPAZ Digital © 2020. Powered by TOPAZ Digital.

Creating and Managing Users

7. Once you have created a User Organization, you can then create User Accounts which will enable your customer to log in and manage their own accounts.
To do this, click on 'Users' on the left side menu.
Here you will see a list of all Users registered under your 'Reseller' account (this includes your own log in).
Click on a User Name to manage and edit it, or click 'Add New' to create a new User.

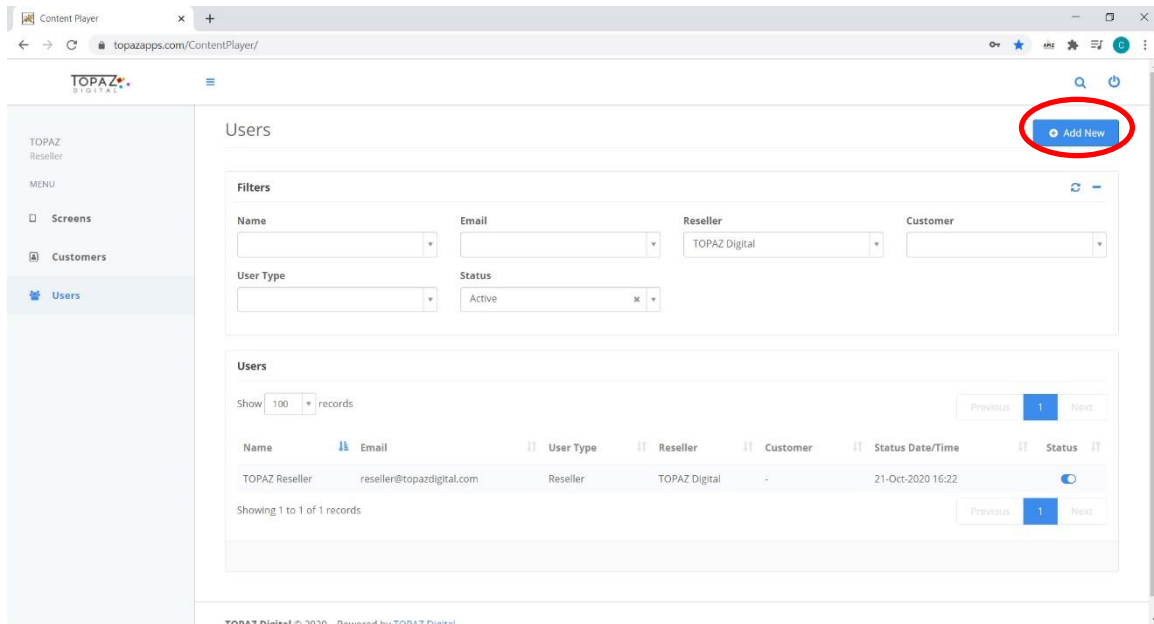

8. On the 'Add New User' screen, you will see the following fields that must be filled in:
 - First name
 - Last Name
 - Email (used for user to log in)
 - Password
 - User type (Only customer can be selected)
 - Reseller (Only your Reseller Account can be selected)
 - Customer (select from here which customer Organization you would like this assigned to)
 - Status (keep as active)

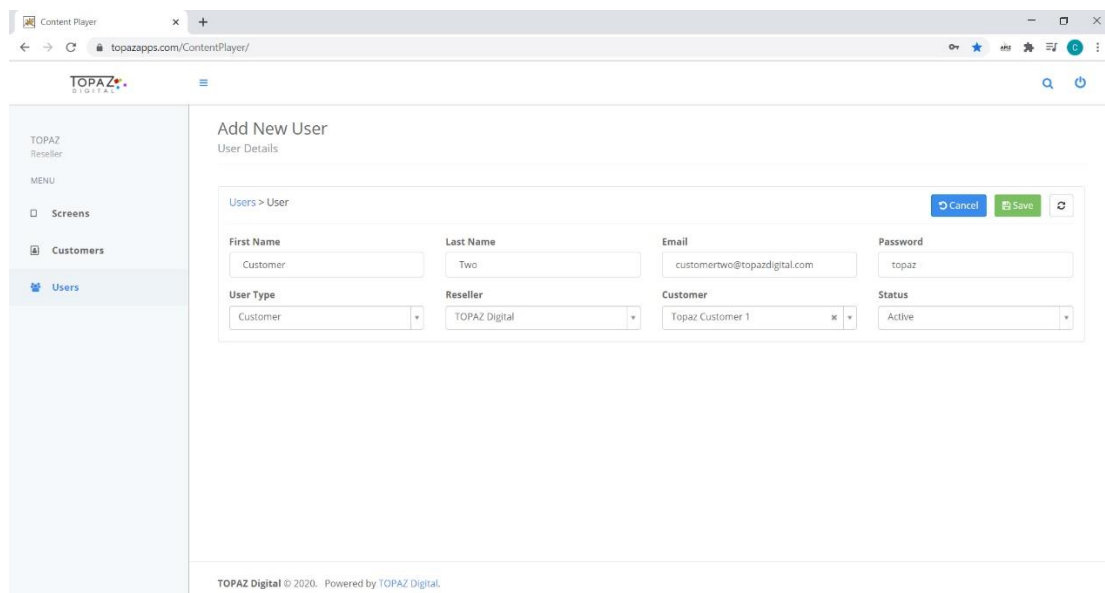

9. Click Save and you will now see the new User in the 'Users' screen.

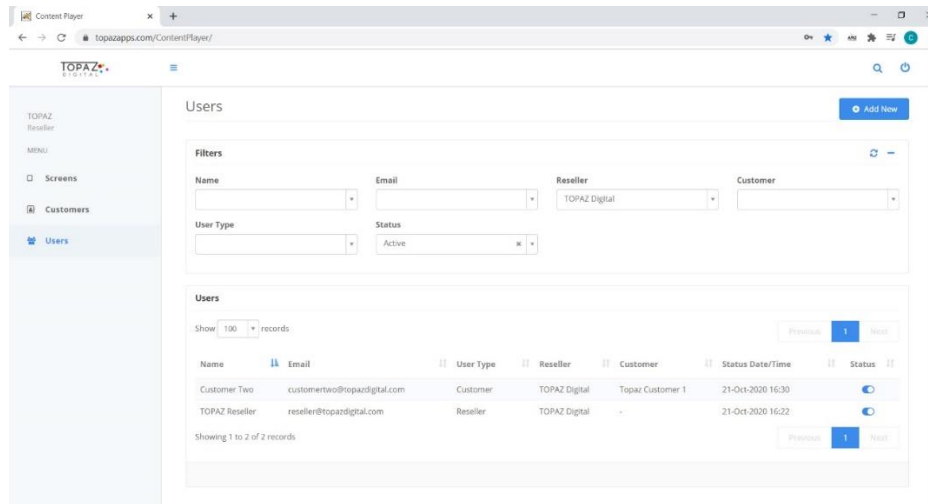

Managing and Assigning Screens

10. When screens have been assigned to your reseller account by TOPAZ, you will see them in the 'Screens' section. Click on the screen to bring up it's information.

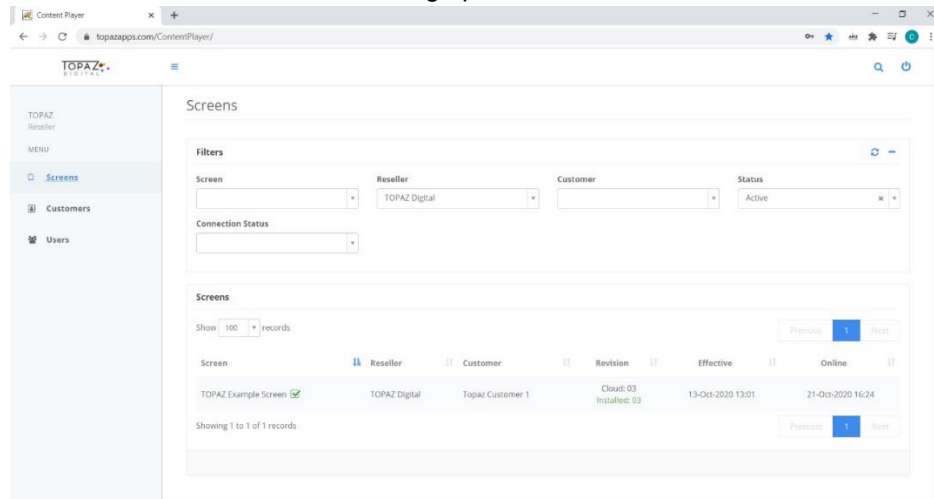

11. To assign the screen to one of your resellers, click the 'Customer' dropdown list and select the relevant customer. You can also type the name of the customer for quick access. Click the Green Save button and the screen will be assigned to the customer.

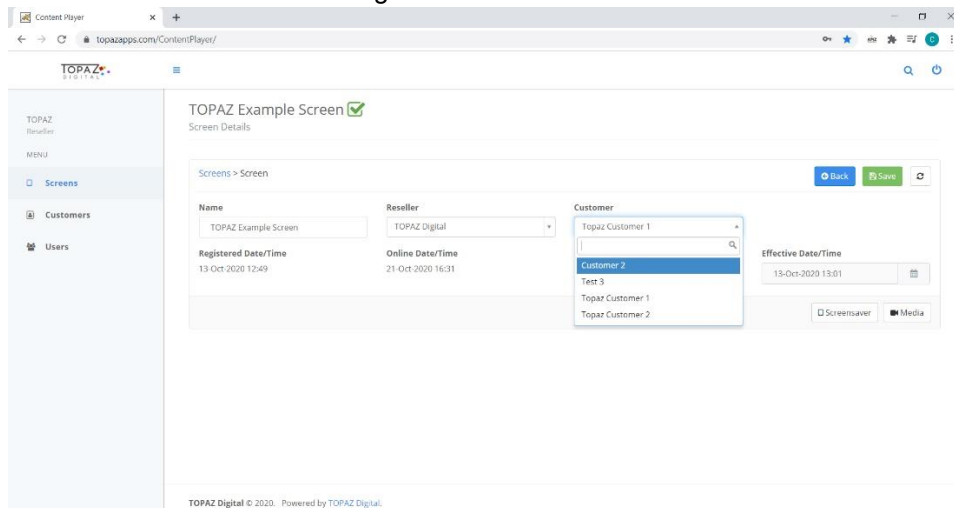

Uploading Content

12. Click on the screen and select the 'Media' icon.

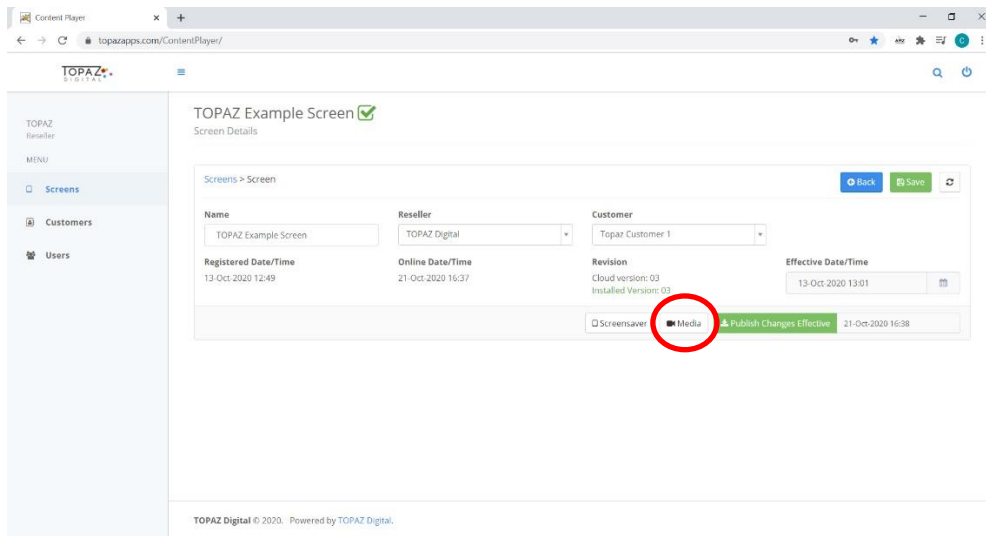

13. Click the 'Upload Photo' or 'Upload Video' button depending on what type of content you want to upload.

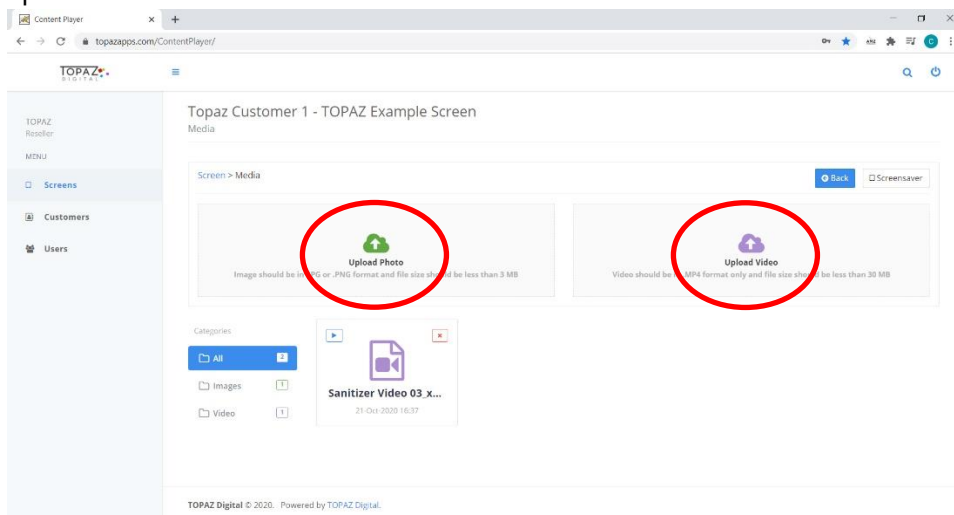

14. Browse to the file location on your computer, select the file and click 'Open'

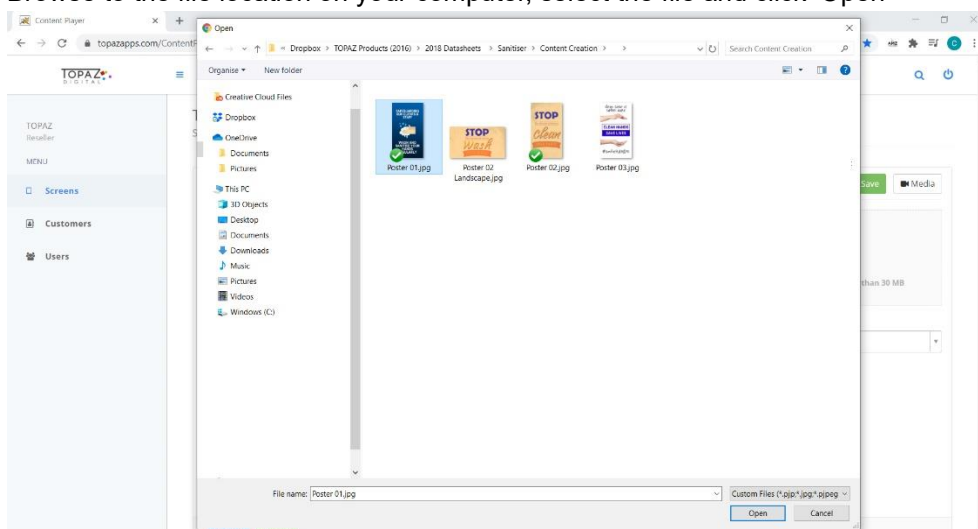

15. The content will then appear in your content library. This content will then be accessible to any user and screen assigned to this Customer.

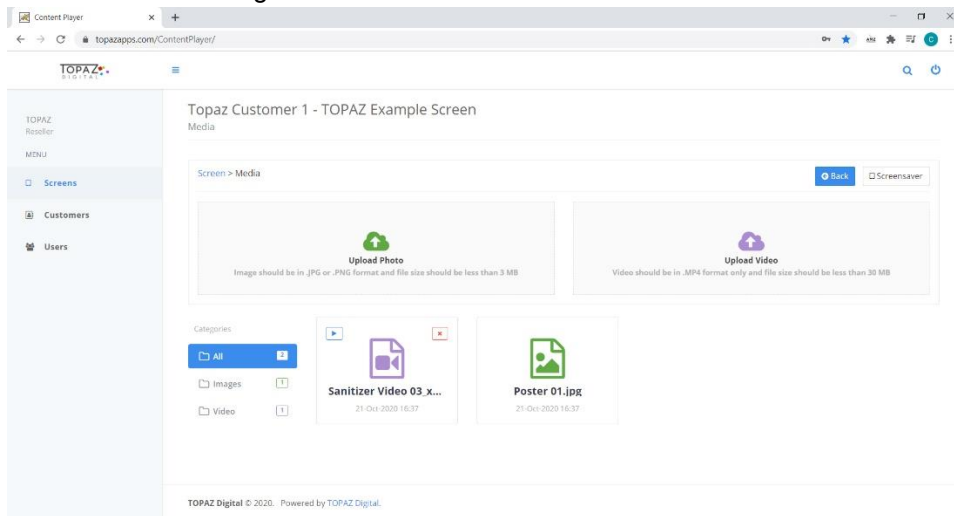

16. To see a preview of the content (shown below), click the blue 'Play' button in the top left of the icon. To delete click the red cross in the top right of the icon.

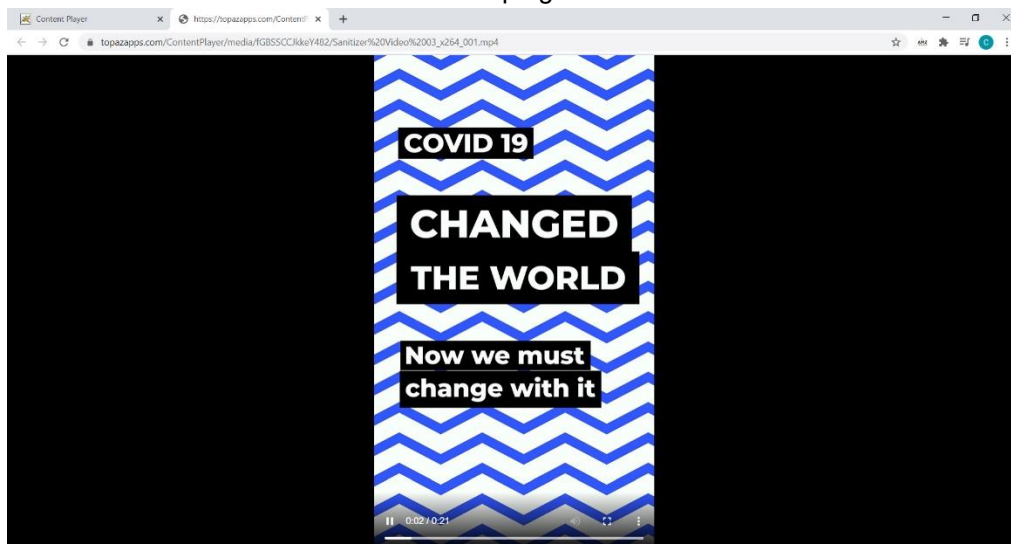

Assigning Content to a Screen

17. Once content has been uploaded and is available to a Customer, click on a Screen and then click on 'Screensaver'.

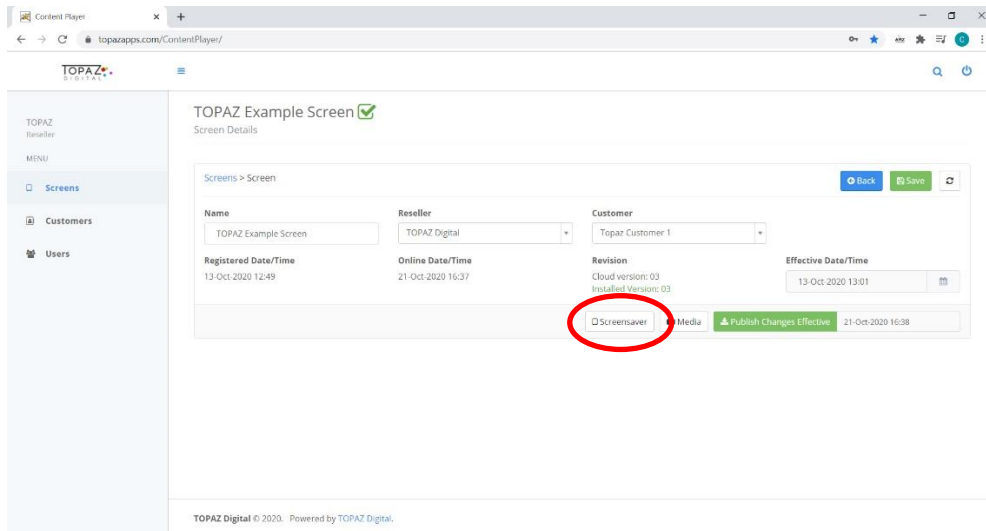

18. From here, you will see a dropdown icon under 'Media 1'. Click on this and all available content will be listed. Select your required content and a new dropdown (Media 2) will appear. Repeat until you have selected all your required content. Click Save

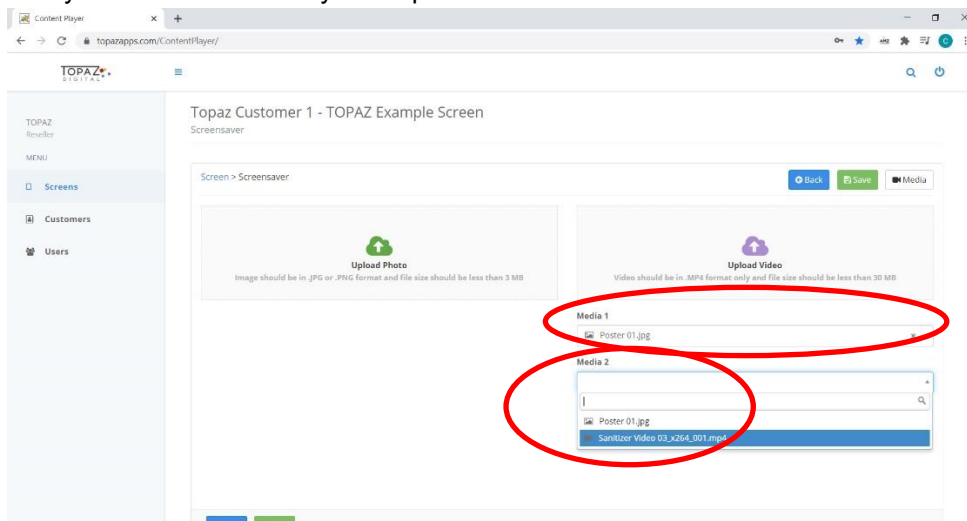

19. Once you have clicked Save, a preview of your content will be visible. Scroll down to see all content. When you are happy with your content, click 'Back'.

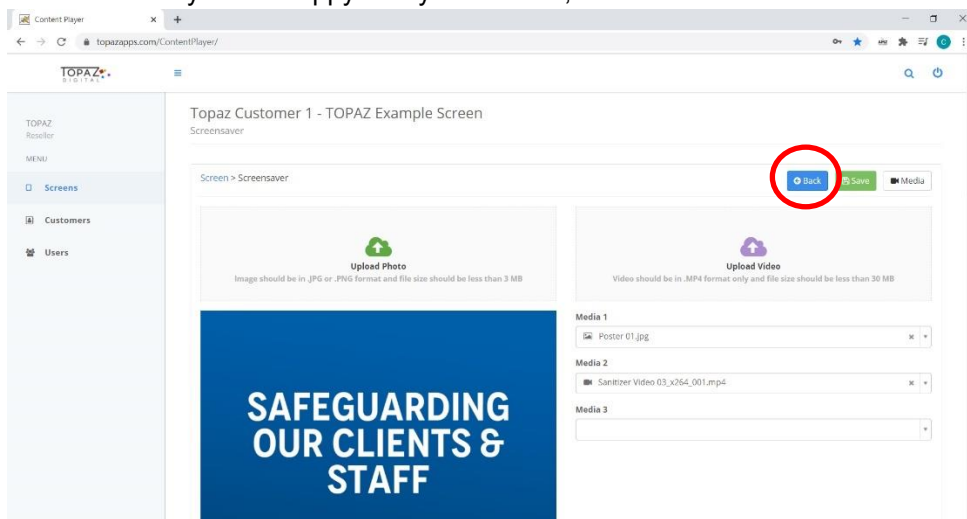

20. You are now able to Publish your changes. To do this immediately, simply click 'Publish Changes Effective'.

To Publish the changes at a future date and time, click the date box and select your date and time then click 'Publish Changes Effective'.

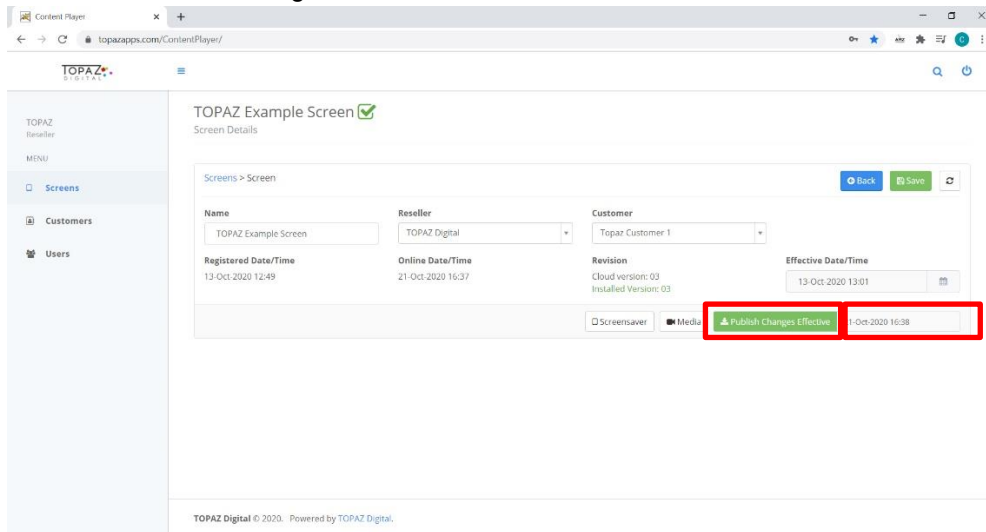

21. Confirm you want to publish the changes and your content will be sent to the screen.

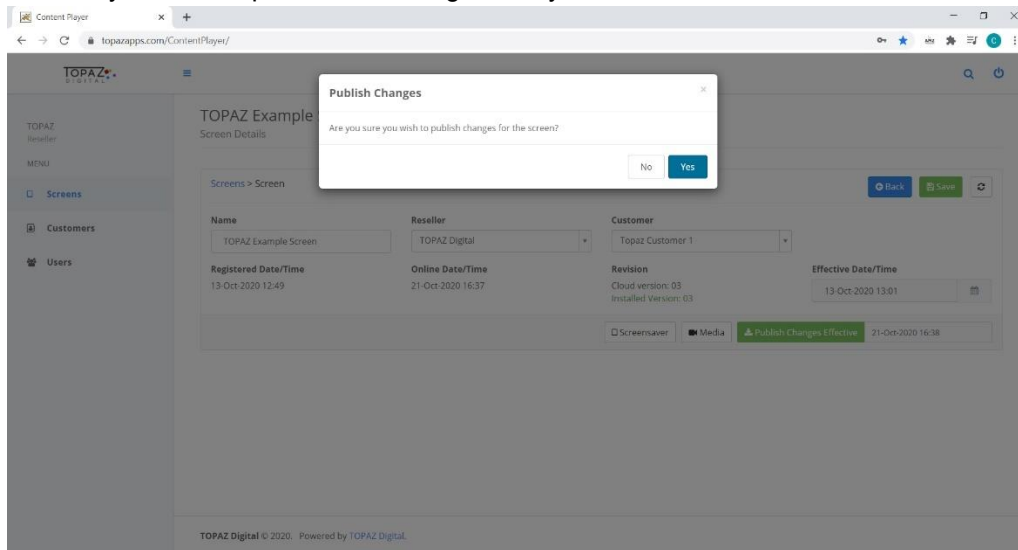

MANAGING YOUR DISPLAYS VIA THE TOPAZ CLOUD CONTENT PLAYER (CUSTOMER ACCOUNT)

Logging In

Once your display(s) have been registered for the Platinum package, you will receive your login details which will allow you to manage your display(s) via the Cloud. Below is how to manage your account as a Customer

1. Open your browser (Chrome recommended) and go to <https://topazapps.com/ContentPlayer/>. Login using the details provided

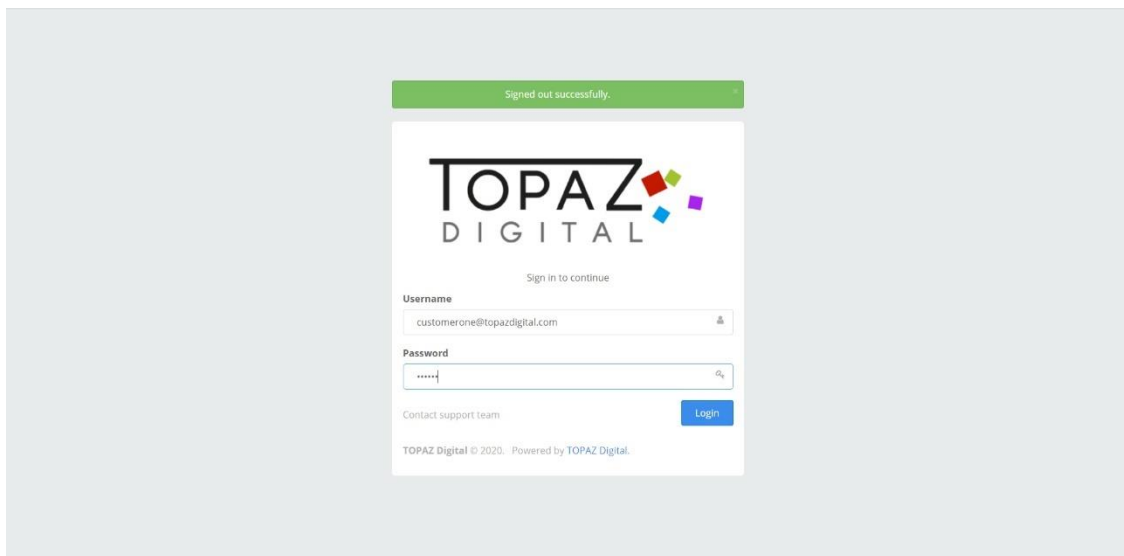

2. Once logged into your account, you will see the 'Screens' section. This will show all screens assigned to your Customer account by your Reseller. In the demo screen below, you can see an orange cross by the screen name (circled below). This means that your screen is currently offline.

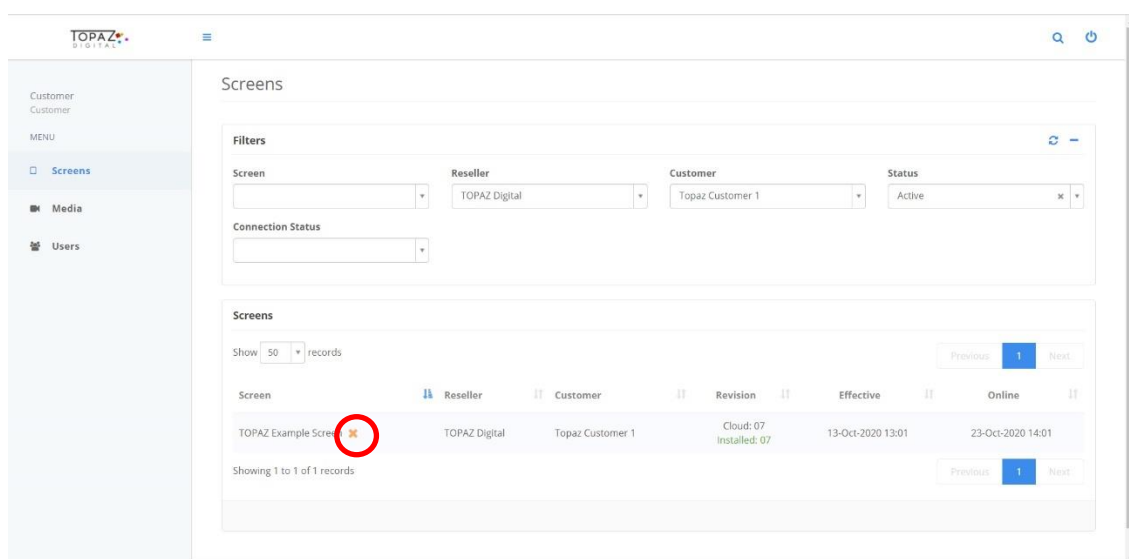

- Once your screen is connected to the internet, this will change to a green tick (see below). Your screen cannot be updated via the cloud unless it is online.

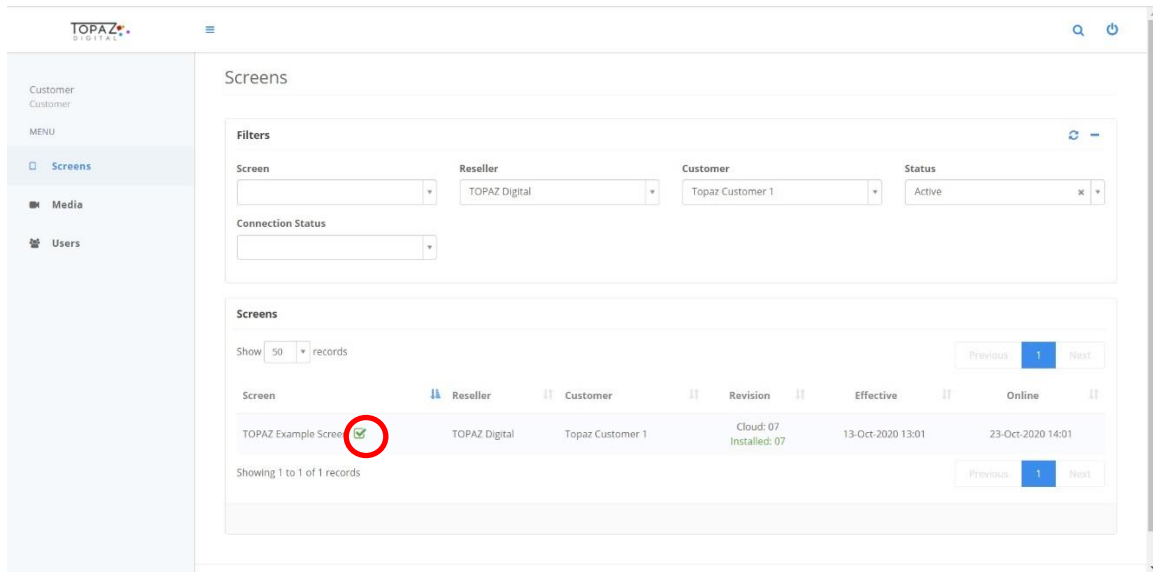

Managing Media

- Click on 'Media' on the left side menu and this will display a list of your current Media items. Click the 'Upload Photo' or 'Upload Video' button depending on what type of content you want to upload.

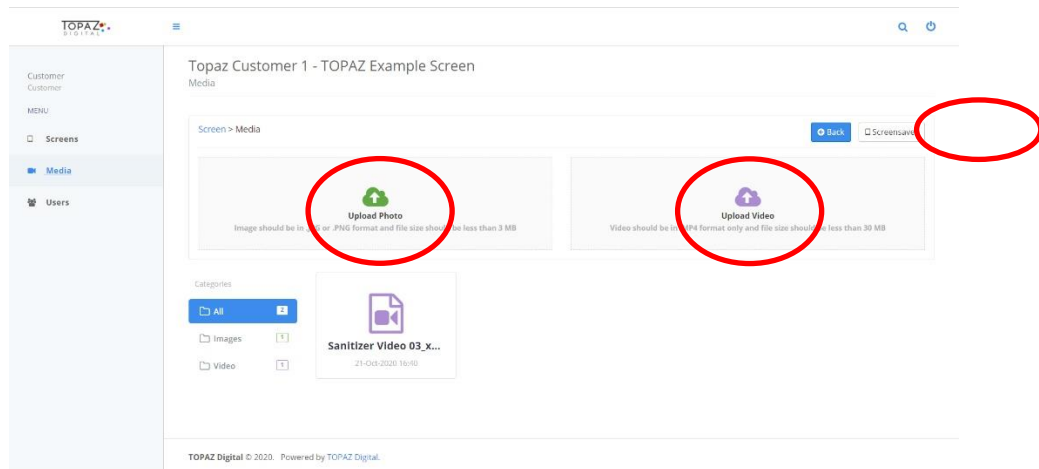

- Browse to the file location on your computer, select the file and click 'Open'

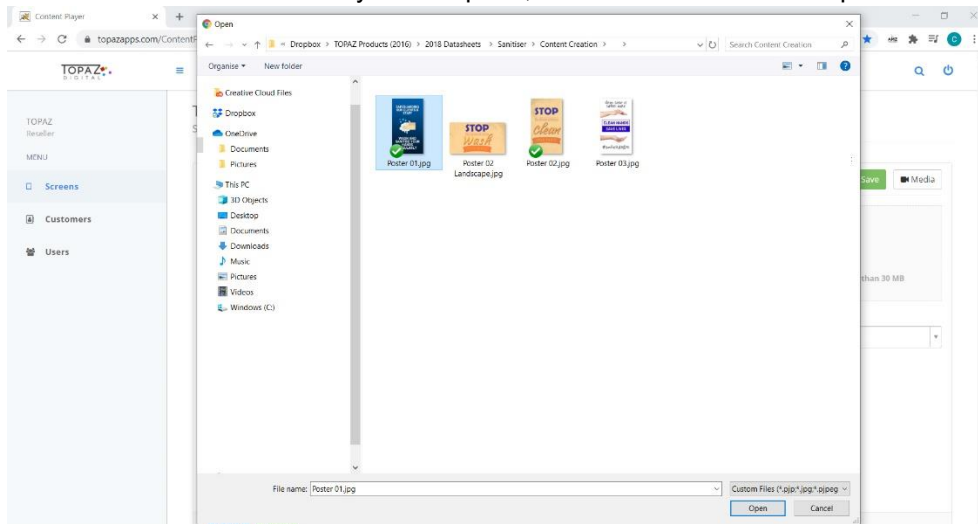

- The content will then appear in your content library. This content will then be accessible to any user and screen assigned to your Customer Account.

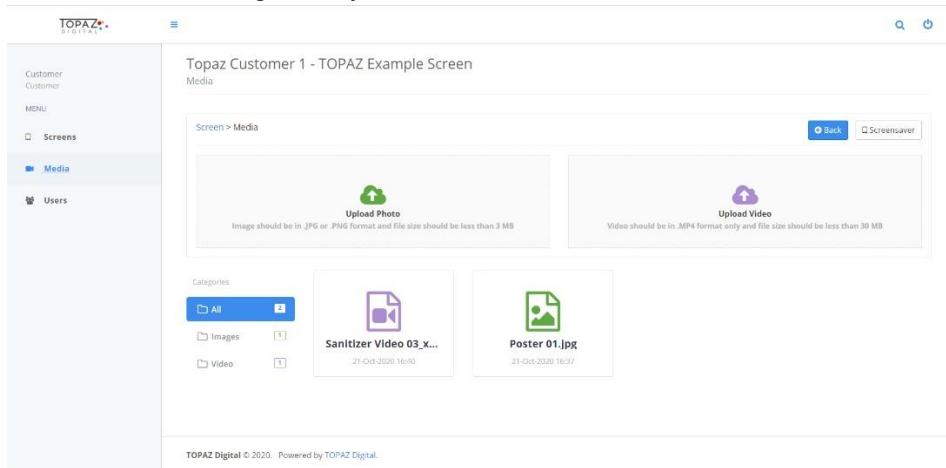

- To see a preview of the content (shown below), click the blue 'Play' button in the top left of the icon. To delete click the red cross in the top right of the icon.

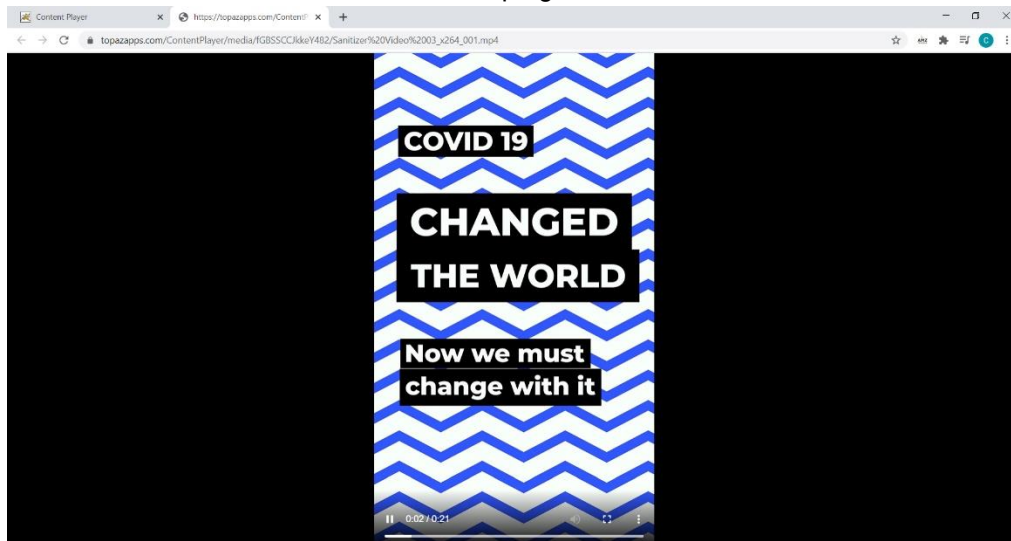

Creating and Managing Users

8. Once you have created a User Organization, you can then create User Accounts which will enable your customer to log in and manage their own accounts.
To do this, click on 'Users' on the left side menu.
Here you will see a list of all Users registered under your 'Reseller' account (this includes your own log in).
Click on a User Name to manage and edit it, or click 'Add New' to create a new User.

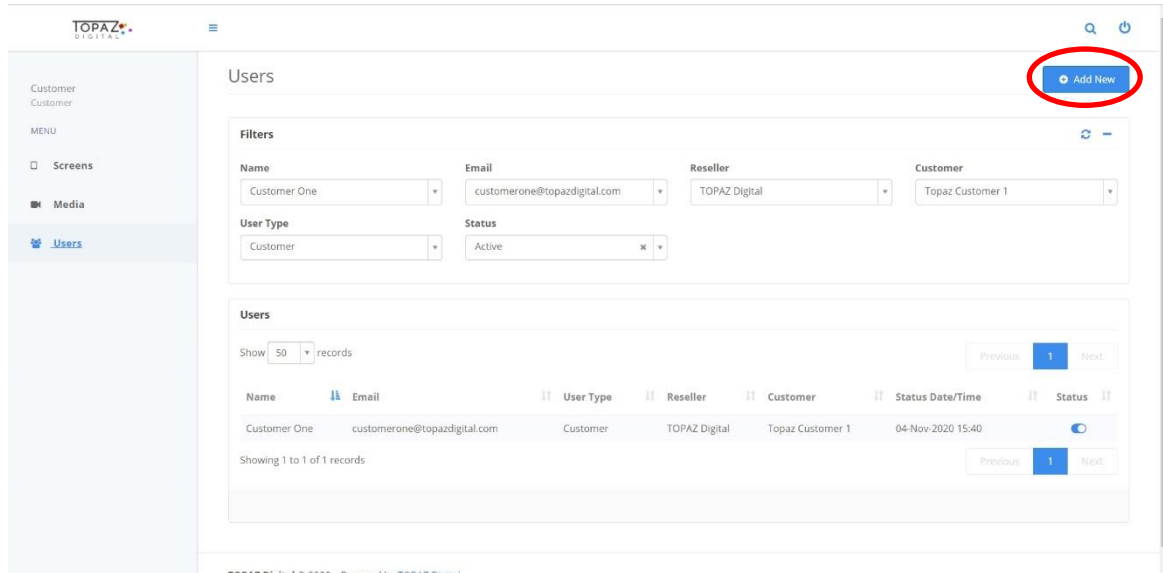

9. On the 'Add New User' screen, you will see the following fields that must be filled in:
 - First name
 - Last Name
 - Email (used for user to log in)
 - Password
 - User type (Only customer can be selected)
 - Reseller (Only your Reseller can be selected)
 - Customer (Only your Customer Account can be selected)
 - Status (keep as active)

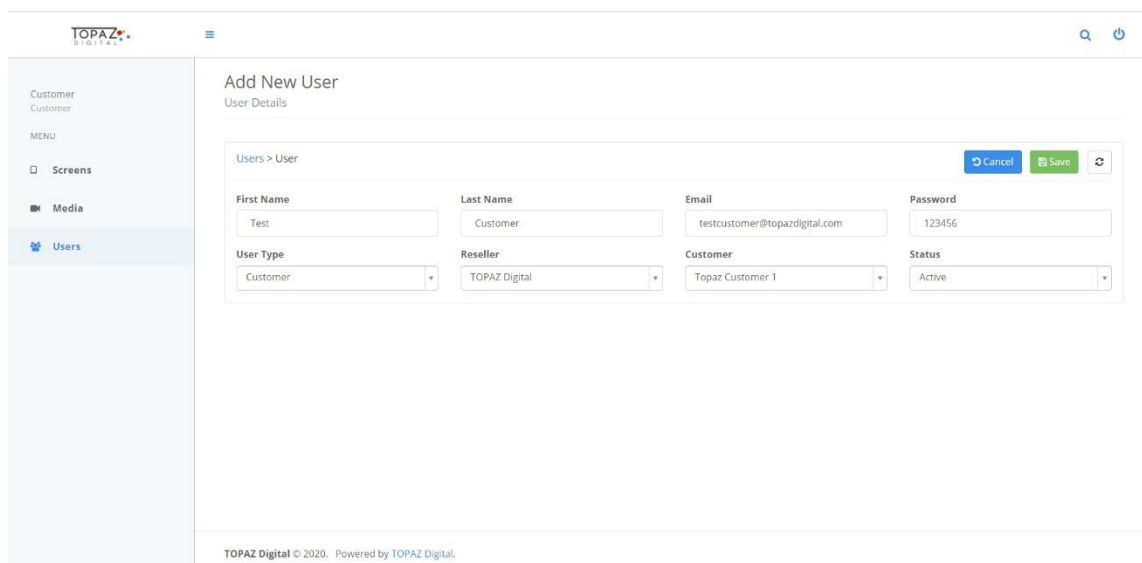

10. Click Save and you will now see the new User in the 'Users' screen.

Managing Screens

11. When screens have been assigned to your reseller account by TOPAZ, you will see them in the 'Screens' section. Click on the screen to bring up it's information.

12. You can change the name of your screen(s) by changing the 'Name' field. Click the Green Save button and the screen name will be changed.

Uploading Content via the screen section.

- Click on the screen and select the 'Media' icon.

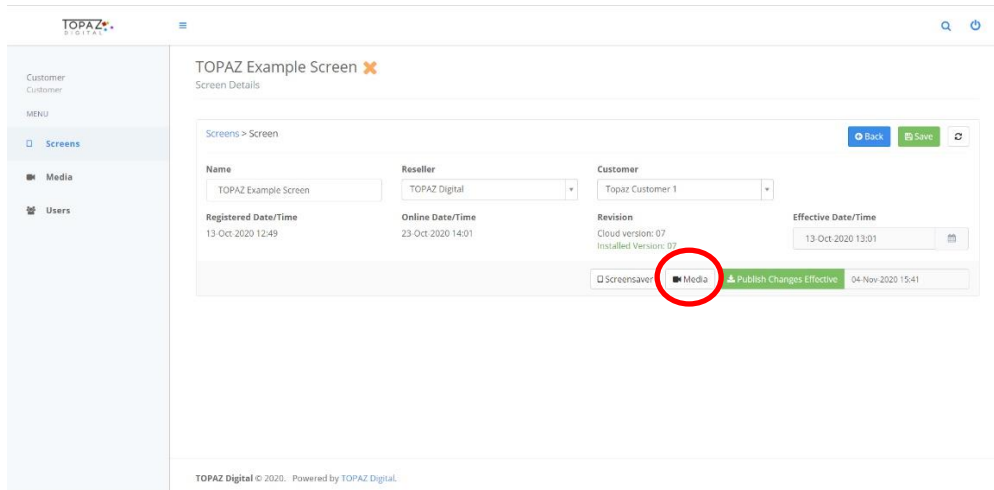

- Repeat steps 4-7

Assigning and Publishing Content to a Screen

- Once content has been uploaded and is available, click on a Screen and then click on 'Screensaver'.

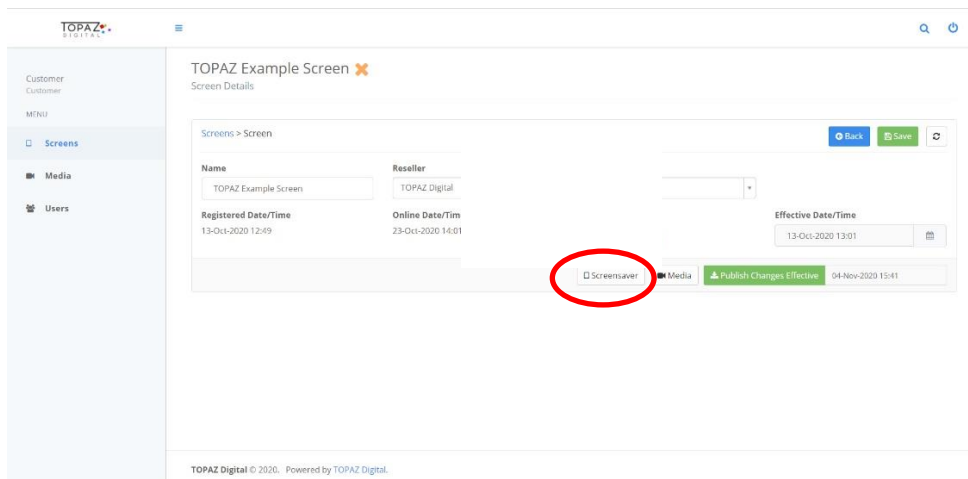

- From here, you will see a dropdown icon under 'Media 1'. Click on this and all available content will be listed. Select your required content and a new dropdown (Media 2) will appear. Repeat until you have selected all your required content. Click Save

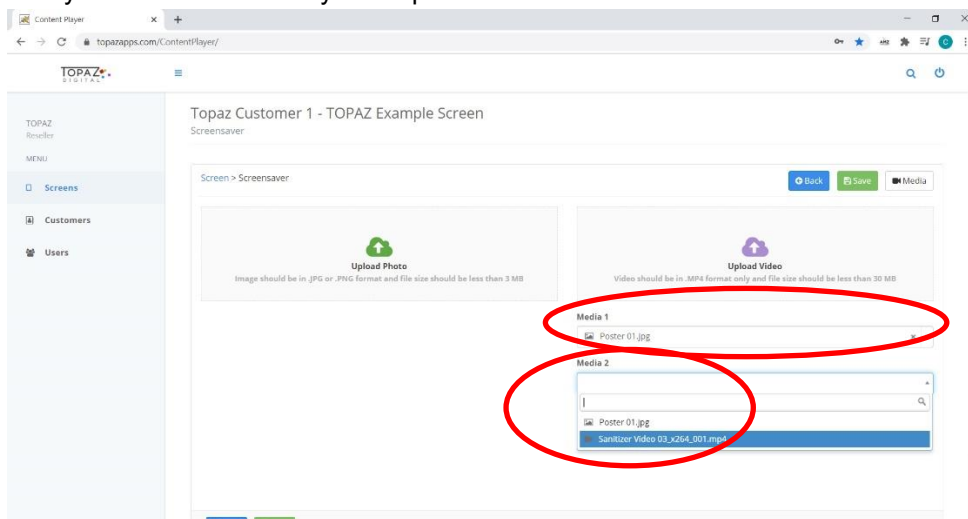

17. Once you have clicked Save, a preview of your content will be visible. Scroll down to see all content. When you are happy with your content, click 'Back'.

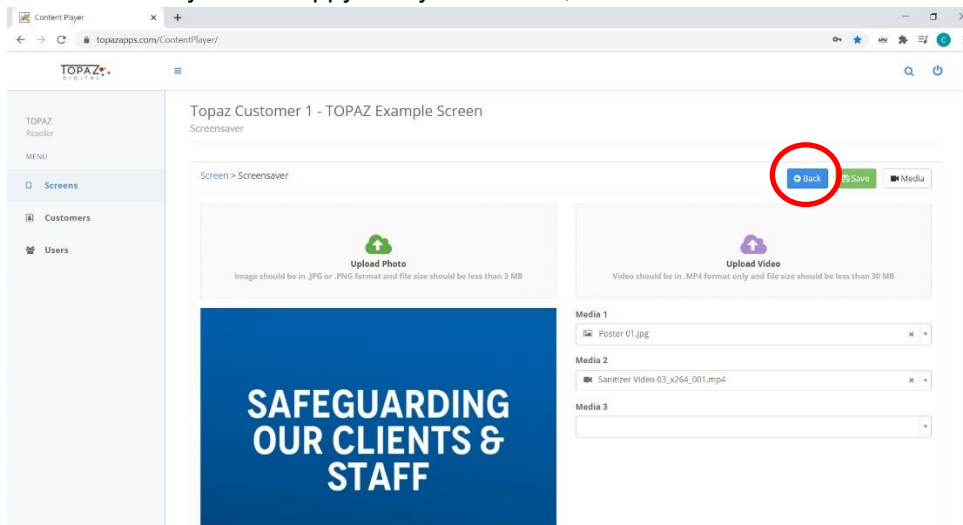

18. You are now able to Publish your changes. To do this immediately, simply click 'Publish Changes Effective'. To Publish the changes at a future date and time, click the date box and select your date and time then click 'Publish Changes Effective'.

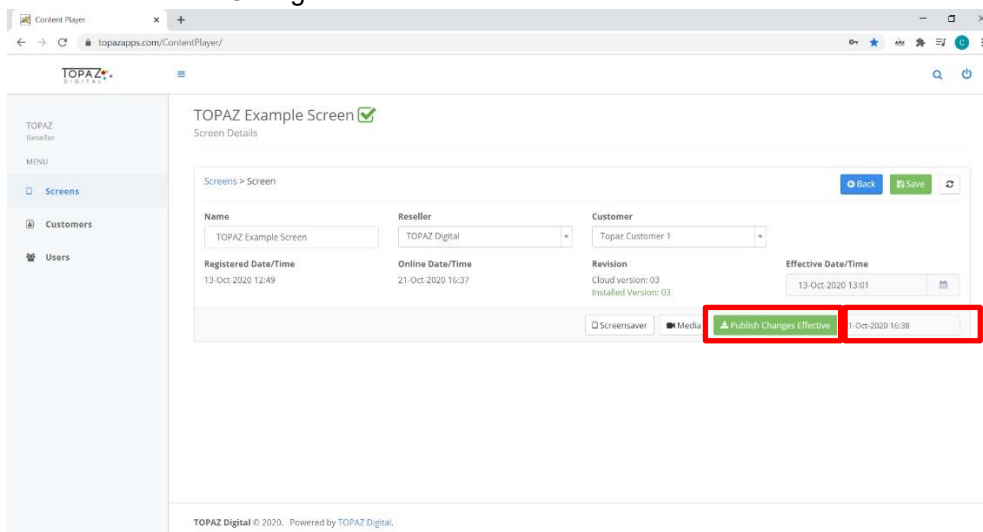

19. Confirm you want to publish the changes and your content will be sent to the screen.

