



22" HAND SANITIZER DISPLAY HARDWARE USER MANUAL

CONTENTS

SUBJECT	PAGE
1. Technical Specification	3
2. Parts and Mounting	4
- Packing List	4
- Steps for Mounting (Wall Mounted)	4
- Steps for Mounting (Freestanding)	5
3. Using the Display for the First Time	6
- Screen Checks	6
4. Remote Control	9
5. Installing/Updating the TOPAZ Content Player Software	10

TECHNICAL SPECIFICATIONS

MODEL NUMBER	TPZ-HSD-22WP (Wall Mounted) TPZ-HSD-22FP (Freestanding)
Panel	
MAX RESOLUTION	1080 x 1920
ASPECT RATIO	9:16
PIXEL PITCH	0.24825 x 0.24825
VIEWING ANGLE	89/89/89/89
CONTRAST RATIO	3000:1
BRIGHTNESS	500cd/m2
RESPONSE TIME	18ms
REFRESH RATE	60Hz
COLOUR SATURATION	68%
VIEWABLE AREA	268.11 x 476.64 mm
CHROMATICNESS	16.7M
INPUT PORTS	
USB 2.0	X2
HDMI OUT	X1
SD	X1
RJ45	X1
SUPPORTED MEDIA	
VIDEO	RMVB,FLV,MPEG1/2/4,AVI,DIVX,XDIV,WMV9,H.264
IMAGE	BMP/PNG/GIF/JPEG
AUDIO	MP3,WMA,WAV
GENERAL	
MATERIAL	Metal
COLOUR	White
CERTIFICATION	CE/ROHS/FCC
24/7 OPERATION?	Yes
PC SPECIFICATIONS	
OPERATING SYSTEM	Android 7.1
PROCESSOR	RK3288 board Quad-core ARM Cortex-A17, 1.8GHz
DDR3	2GB
FLASH	8GB
MECHANICAL	
NET WEIGHT	18kg (screen) 10kg (stand) *Freestanding only
GROSS WEIGHT	22kg (screen) 30kg (stand) *Freestanding only
UNIT DIMS	618.6 x 70 x 290.9 (screen) 450 x 350 x 1018 (stand) *Freestanding only
PACKAGE DIMS	800 x 320 x 530 (screen) 1100 x 490 x 630 (stand) *Freestanding only
MATERIAL	Metal
COLOUR	White
SANITIZER VOLUME	5000ml
POWER/ENVIRONMENT	
VOLTAGE	AC100-240V
POWER CONSUMPTION	60W
OPERATING TEMPERATURE	32~104 °F (0~40 °C)

PARTS AND MOUNTING

Packing List

Wall Mounted
1x Power Cord
3x Keys
1x 6mm Allen Wrench
2x M4x30 screws

Freestanding
1x Power Cord
4x Keys
1x 6mm Allen Wrench
6x M8x25 screws
4x Foot Pad

Steps for Mounting – Wall Mounted

1. Securely fix the wall bracket onto the back of the screen.
2. Using two people, lift the display onto the bracket.
3. Screw the small fixing screw into the side of the bracket to lock the screen in place.

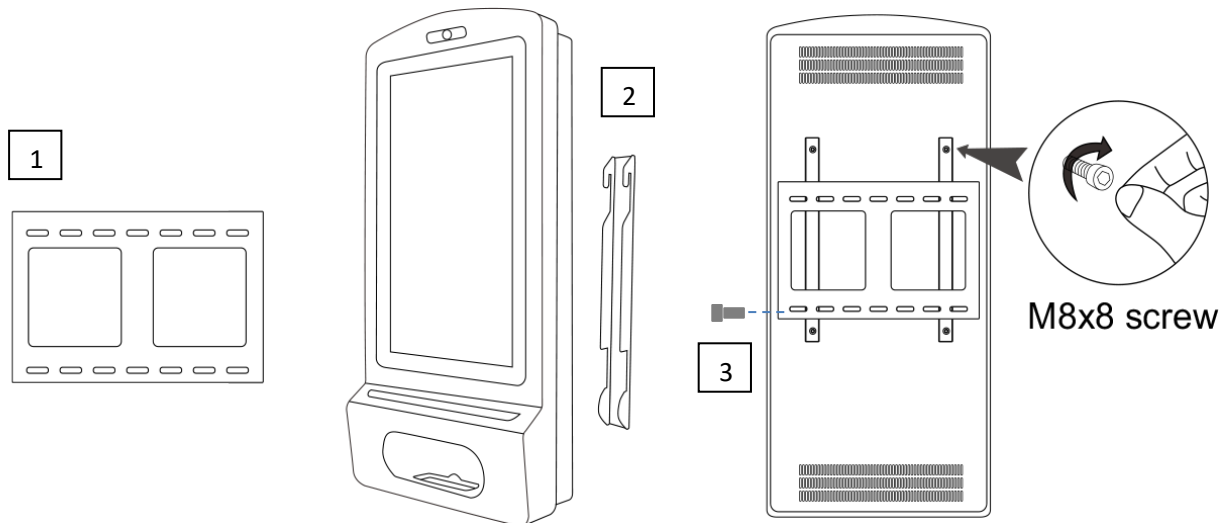

Steps for Mounting – Freestanding

1. Place the floor plate in location and bolt to the floor using M8 Bolts.
2. Slide Floor stand onto floor plate and screw in place
3. Using two people, carefully lift the display onto the floor stand
4. Use M8 screws to secure the frame into the bottom of the screen.
5. Lock Stand to Base tightly with the key

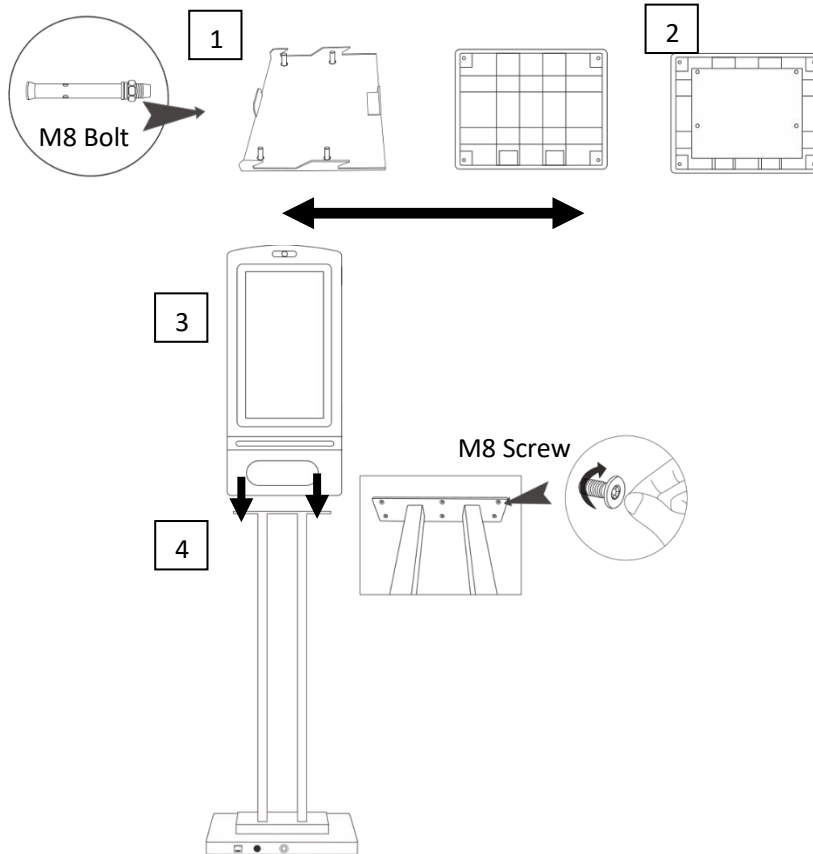

1) Bolt Plate to floor

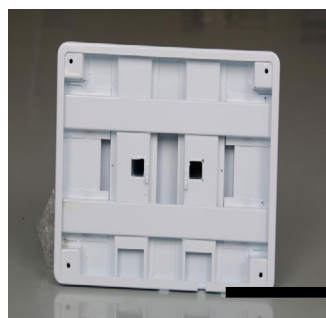

2) Slide floor stand onto floor plate

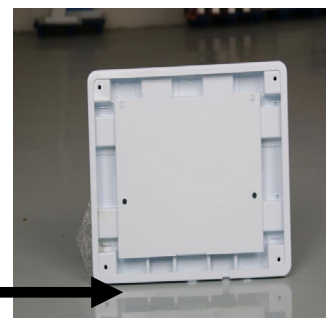

5) Lock Stand to Base tightly with the key

NOTE – Please ensure that the floor stand is securely bolted to the floor. TOPAZ Digital will not be held liable for any damage or injury for failure to do so.

USING THE DISPLAY FOR THE FIRST TIME

Screen Checks

1. Power on the display and check volume indicator

Power on the display. The sanitizer volume indicator should display as red.



2. Checking Dispenser Border Light

The dispenser border light should display as blue when not in use. Place your hand in the dispenser to activate the sensor. A click should be heard and the border light should change to green.



3. Deciding what type of Sanitizer you wish to use

Before use, please decide whether Liquid or Gel Sanitizer will be used.

4. Opening the unit

Use the keys provided to open the two locks on the side of the unit and carefully open the display



5. Liquid Sanitizer

If you are using liquid sanitizer, ensure that the button highlighted below is pressed **IN**.



Ensure the following dispenser head is being used for **Liquid Sanitizer**:



6. Gel Sanitizer

If you are using Gel sanitizer, ensure that the button highlighted below is pressed **OUT**.



Ensure the following dispenser head is being used for **Gel Sanitizer**:

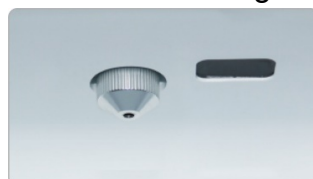

NOTE – to change the dispenser, simply unscrew and replace.













7. Pour in your Sanitizer

Unscrew the blue cap and carefully pour in your required sanitizer.

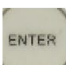

REMOTE CONTROL



-  1. Power off button
-  2. Press this button to return to Home screen
-  3. Press MENU to organize screen and apps
-  4. Mute.
-  5. Move selection Up
-  6. Move Selection Down
-  7. Move selection Left
-  8. Move selection Right
-  9. Enter – press to confirm selection
-  10. Volume up
-  11. Volume Down
-  12. Exit – Press to return to previous page.

NOTE – Only buttons shown above have functions

INSTALLING/UPDATING THE TOPAZ CONTENT PLAYER SOFTWARE

1. Request the latest APK installation file from TOPAZ Digital or your reseller.
2. On your computer, copy the APK file onto a blank USB memory stick. Once copied, safely remove the USB from your computer.

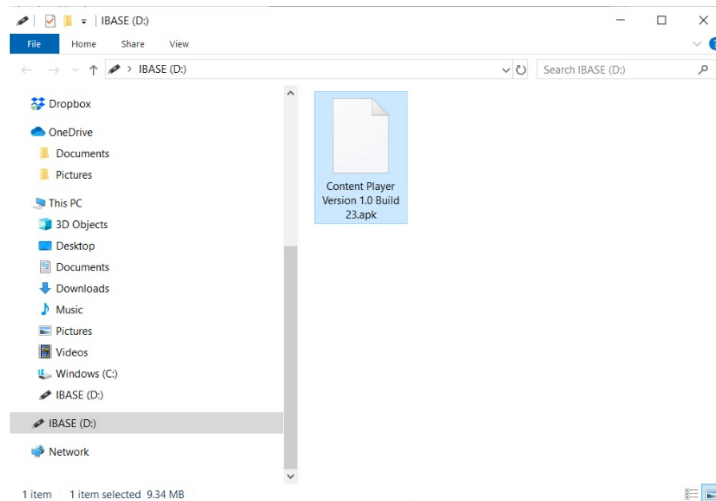

3. Turn on the Hand Sanitizer Display
4. Use the keys provided to open the two locks on the side of the unit and carefully open the display

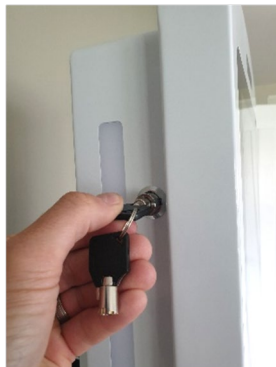

5. Insert the USB memory stick into USB Port 1 and a USB mouse into USB Port 2.

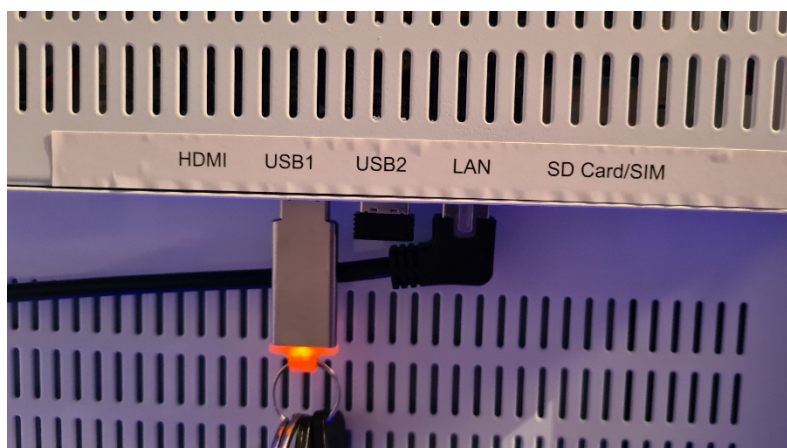

6. A pop up will appear in the middle of the screen and the black Android navigation bar will appear at the bottom of the display. Click the white circle in the centre of the bottom black bar (circled below)

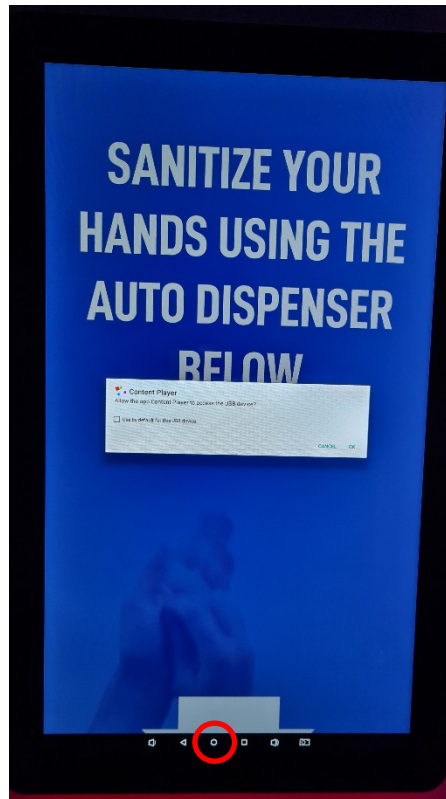

7. Select the white circle highlighted below

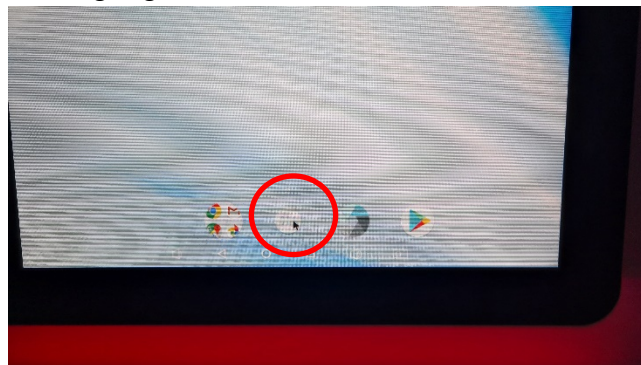

8. Select the 'Explorer' icon highlighted below

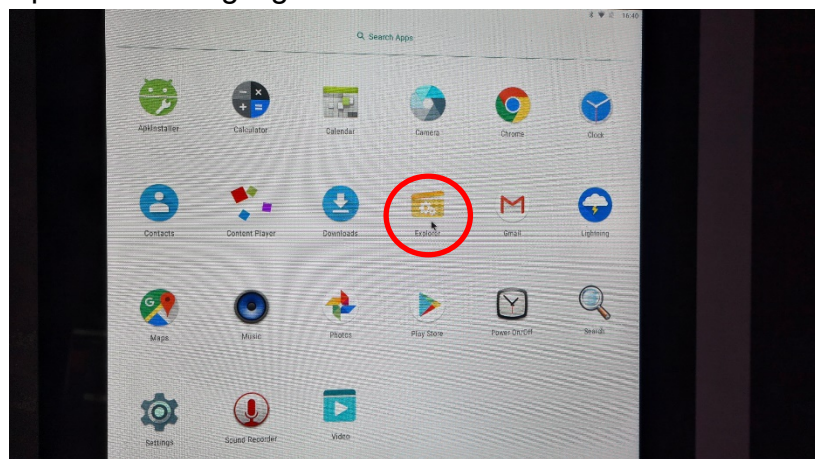

9. Select USB

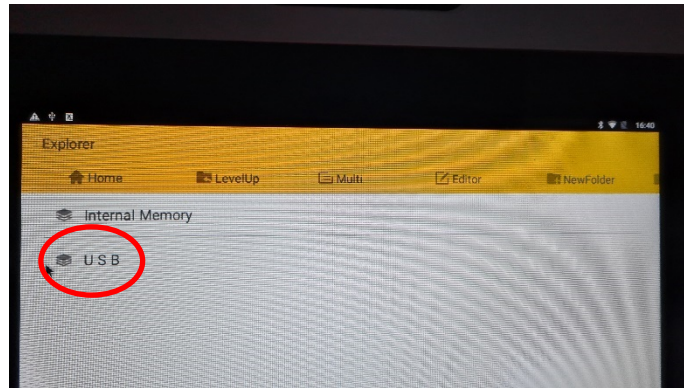

10. Select the Content Player APK file saved on the USB

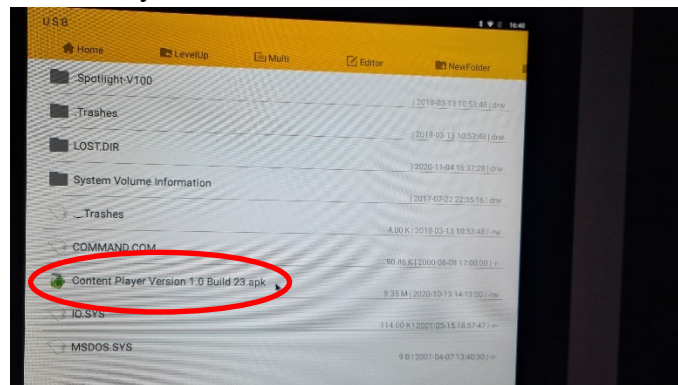

11. Select 'Install' and the APK will install onto the unit. Once complete, click Open

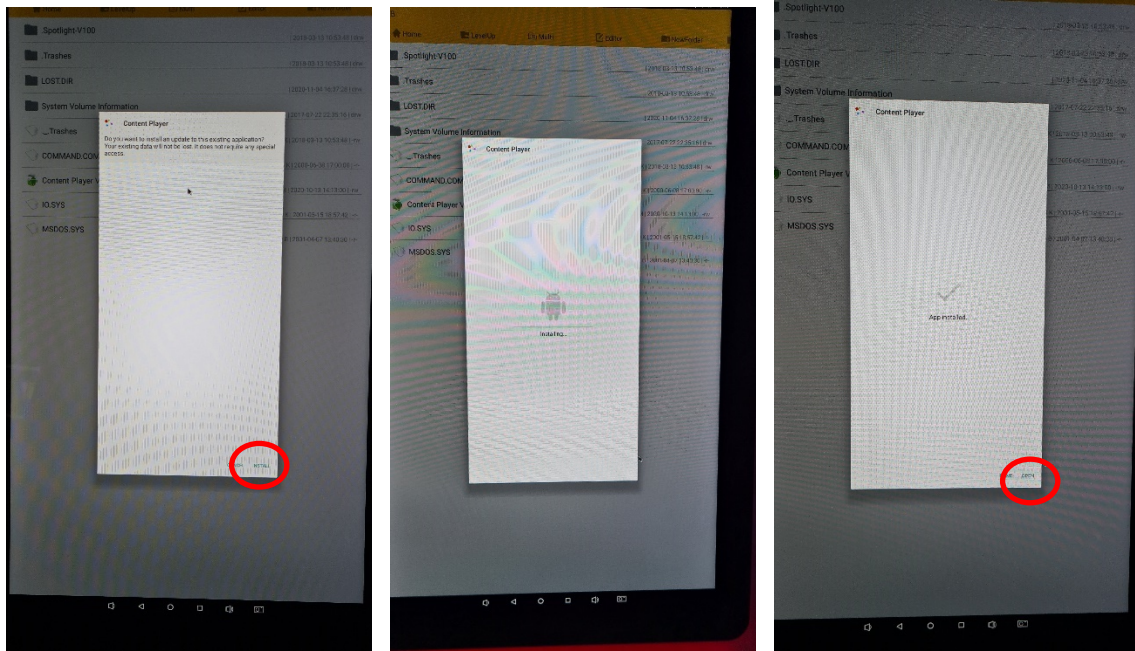

12. The Content will now begin to play and the software has been successfully installed.